



**BONE**

TRAUMA & SPINE SOLUTIONS



Implants  
Catalogue

[www.bone-ti.com](http://www.bone-ti.com)

# Trauma & Spine Solutions

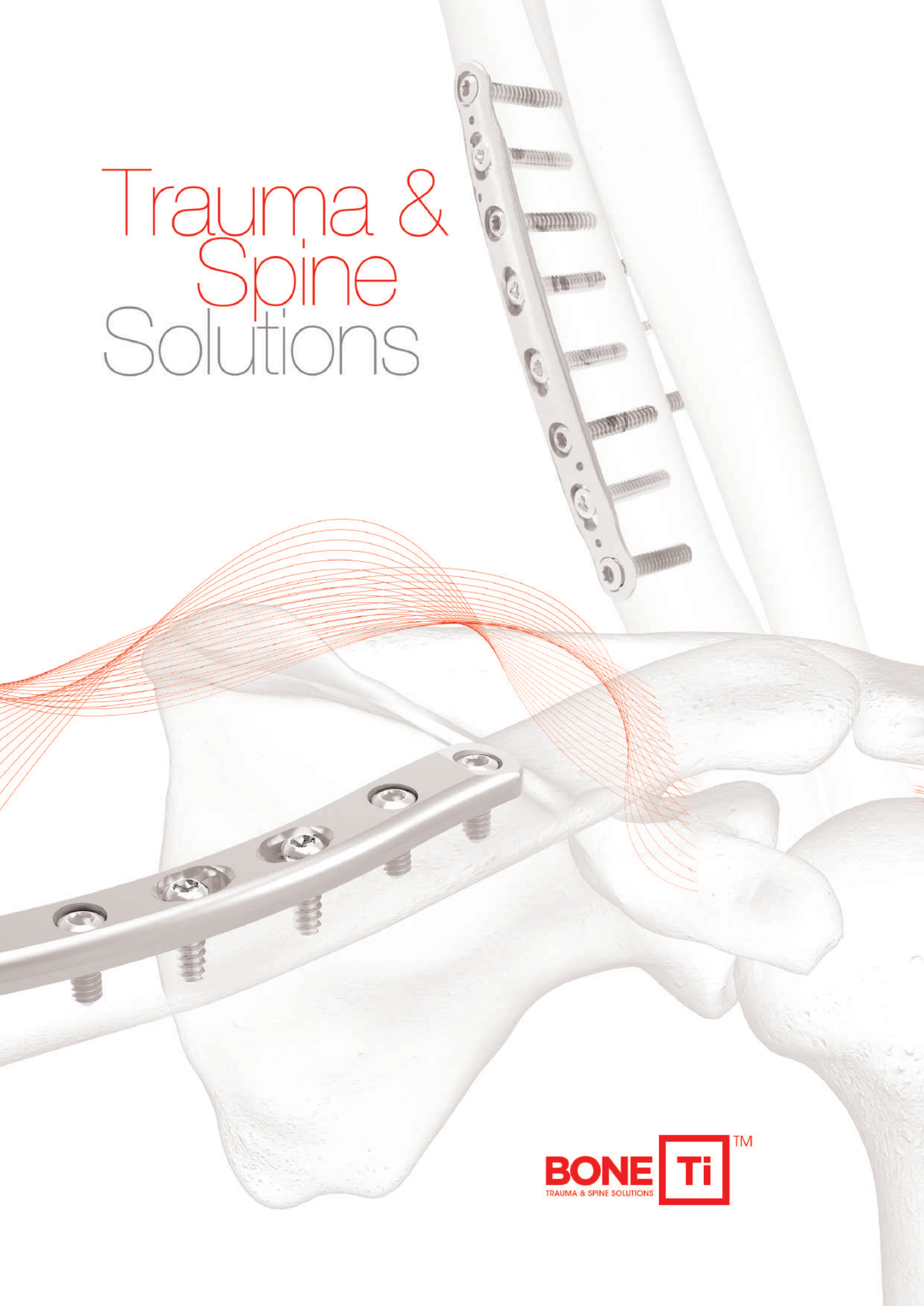

# Contents

Introduction .....	1
Indications .....	1
Features & Benefits.....	2
<b>Trauma</b>	
<b>Small Fragment Plate System</b>	
Clavicle Plates .....	5
Humerus Plates .....	7
Radius Plates.....	11
Ulna Plates .....	15
Calcaneus Plates .....	16
<b>Large Fragment Plate System</b>	
Femoral Plates.....	17
Tibial Plates .....	20
Fibula Plates .....	24
Pelvis Plates .....	25
<b>Multifunctional Plate System</b>	
Multifunctional Plates .....	26
<b>Mini Plate System</b>	
Mini Plates .....	28
<b>Screw System</b>	
Cortical and Cancellous Screws .....	34
Locking Screws .....	39
Cannulated Screws .....	43
Headless Compression Cannulated Screws .....	47
<b>Nail System</b>	
Proximal Femoral Nail System PFN .....	51
Proximal Femoral Nail System EFN .....	54
Tibial Nail System TN .....	56
Tibial Nail System ETN .....	58

## INTRODUCTION

The locking screw concept was produced by Dr. Tepic S and Dr. Perren SM for the first time in 1995. With locking compression plate put in use, it became one of the most important developments for plate and screw internal fixation in recent years. Locking screws provide the ability to create a fixed-angle construct while utilizing familiar conventional plating techniques. The fixed-angle constructed functions as an internal fixator which maintains primary and secondary loss of reduction. This kind of construction also provides improved fixation in osteopenic bone or multifragment fractures, where traditional screw purchase is compromised. LCP constructs do not rely on plate-to-bone compression to maintain stability. Therefore, the periosteum will be protected and the blood supply to the bone preserved. With these notorious improvements, the LCP becomes an implant category of increasing importance for trauma treatment.

El concepto de tornillo de bloqueo fue producido por el Dr. Tepic S y el Dr. Perren SM por primera vez en 1995. Con la placa de compresión bloqueada puesta en uso, se convirtió en uno de los desarrollos más importantes para la fijación interna de placas y tornillos en los últimos años. Los tornillos de bloqueo proporcionan la capacidad de crear una construcción de ángulo fijo mientras se utilizan técnicas familiares de placas convencionales. La construcción de ángulo fijo funciona como una fijación interna que mantiene la pérdida primaria y secundaria de reducción. Este tipo de construcción también proporciona una fijación mejorada en hueso osteopénico o fracturas multi-fragmentarias donde el uso de tornillos tradicionales está comprometido. La construcción de placas LCP no dependen de la compresión de placa a hueso para mantener la estabilidad. Por lo tanto, el periostio estará protegido y el suministro de sangre al hueso conservado. Con estas notables mejoras, el LCP se convierte en una categoría de implantes de creciente importancia para el tratamiento de traumatismos.

## INDICATIONS INDICACIONES

The LCP system applies to many different plate types and is therefore suitable for a large number of fracture types.

El sistema LCP se aplica a muchos tipos de placas diferentes y por lo tanto es adecuado para un gran número de tipos de fractura.

- Fractures  
Fracturas
- Osteotomies  
Osteotomías
- Malunions, nonunions  
Malas uniones, No uniones

## FEATURES & BENEFITS CARACTERÍSTICAS & BENEFICIOS

- The unique locking hole design.  
Diseño de único orificio de bloqueo
- The locking holes allow placement of conventional cortex and cancellous bone screws, or locking screws on the same hole\*.  
Los orificios de bloqueo permiten la colocación de tornillos corticales convencionales y esponjosos y / o tornillos de bloqueo en el mismo orificio\*.

*\*Not for all locking compression plates.*

*\*No para todas las placas de compresión bloqueadas.*



- Combi holes.  
Orificios combinados
- The Combi holes allow placement of conventional cortex and cancellous bone screws, on one side, or threaded conical locking screws on the opposite side of each hole.  
Los orificios combinados permiten la colocación de los tornillos convencionales corticales y esponjosos en un lado, o tornillos de bloqueo cónicos roscados en el lado opuesto de cada orificio.



## FEATURES & BENEFITS CARACTERÍSTICAS & BENEFICIOS

- Periarticular plates anatomically designed.  
Placas periarticulares con diseño anatómico.
- Periarticular plates are pre-contoured to create an anatomical fit, that requires little or no additional bending and minimizes impinging on soft tissue.  
Las placas periarticulares están preformadas para crear un ajuste anatómico que requiere poca o ninguna incisión adicional y minimiza la incidencia en los tejidos blandos.



- Locking screw with StarDrive recess.  
Tornillo de bloqueo con ranura de estrella
- The StarDrive recess provides improved torque transmission to the screw, and minimizes the possibility of cross thread.  
La ranura de estrella proporciona una mejor transmisión de torque al tornillo y minimiza la posibilidad de enrosque transversal.

- Locking screw with self-tapping flutes .  
Tornillo de bloqueo con bordes auto-perforantes.
- Less surgical steps  
Menos pasos quirúrgicos.



## FEATURES &amp; BENEFITS

## CARACTERÍSTICAS &amp; BENEFICIOS

- Cortical thread with large core diameter.  
Rosca cortical con diámetro de núcleo grande.
- The large core diameter improves bending and shears strength of the screw, and distributes the load over a larger area in the bone.  
El gran diámetro del núcleo mejora la flexión y la resistencia al corte del tornillo y distribuye la carga sobre un área mayor en el hueso.



- Special double-lead thread beneath the screw head engages and locks into the threaded holes of the plate .  
El labrado de doble rosca especial bajo la cabeza del tornillo se engancha y bloquea en los orificios roscados de la placa.
- Easier and faster locking of the screws with the plates.  
Fácil y rápido bloqueo de los tornillos con las placas.



**Clavicle Plates**

**Small Locking Fragment Plating System SLP  
LCP Clavicle Hook Plate**

Matching Screw: 3.5mm Cortical Screw, 4.0mm Cancellous Screw, 3.5mm locking screws



Head thickness    Thickness    Head width    Width  
2.5                    3.6                    25.6                11

Hole	Direction	P.N	Length	Material
4	Left	122236104	41mm	Titanium
5	Left	122236105	53mm	Titanium
6	Left	122236106	64mm	Titanium
7	Left	122236107	74mm	Titanium
4	Left	122236204	41mm	Titanium
5	Left	122236205	53mm	Titanium
6	Left	122236206	64mm	Titanium
7	Left	122236207	74mm	Titanium
4	Right	122236304	41mm	Titanium
5	Right	122236305	53mm	Titanium
6	Right	122236306	64mm	Titanium
7	Right	122236307	74mm	Titanium
4	Right	122236404	41mm	Titanium
5	Right	122236405	53mm	Titanium
6	Right	122236406	64mm	Titanium
7	Right	122236407	74mm	Titanium

**Small Locking Fragment Plating System SLP  
LCP Superior Anterior Clavicle with Lateral Extension  
Locking Plate**

Matching Screw: 3.5mm Cortical Screw, 4.0mm Cancellous Screw, 3.5mm locking screws, 3.5mm spacer, 2.4/2.7mm locking screw



Head thickness    Thickness    Head width    Width  
3.0                    3.0                    18                    10

Hole	Direction	P.N	Length	Material
3	Left	122264103	69mm	Titanium
4	Left	122264104	81mm	Titanium
5	Left	122264105	94mm	Titanium
6	Left	122264106	108mm	Titanium
7	Left	122264107	123mm	Titanium
8	Left	122264108	135mm	Titanium
3	Right	122264203	69mm	Titanium
4	Right	122264204	81mm	Titanium
5	Right	122264205	94mm	Titanium
6	Right	122264206	108mm	Titanium
7	Right	122264207	123mm	Titanium
8	Right	122264208	135mm	Titanium

**Small Locking Fragment Plating System SLP  
LCP Superior Anterior Clavicle Locking Plate**

Matching Screw: 3.5mm Cortical Screw, 4.0mm Cancellous Screw, 3.5mm locking screw, 3.5mm spacer



Hole	Direction	P.N	Length	Material
6	Left	122265106	94mm	Titanium
7	Left	122265107	110mm	Titanium
8	Left	122265108	120mm	Titanium
6	Right	122265206	94mm	Titanium
7	Right	122265207	110mm	Titanium
8	Right	122265208	120mm	Titanium



**Clavicle Plates**

**Small Locking Fragment Plating System SLP  
Clavicle Reconstruction Locking Plate**

Matching Screw:

3.5mm Cortical Screw, 3.5mm locking screw, 3.5mm spacer



Hole	Direction	P.N	Length	Material
6	Left	122232106	70.5mm	Titanium
8	Left	122232108	94.5mm	Titanium
10	Left	122232110	118.5mm	Titanium
12	Left	122232112	142.5mm	Titanium
6	Right	122232206	70.5mm	Titanium
8	Right	122232208	94.5mm	Titanium
10	Right	122232210	118.5mm	Titanium
12	Right	122232212	142.5mm	Titanium

## Humerus Plates

### Small Fragment Plating System CanSFP Distal Posterior / Lateral Humeral Plate

Matching Screw: 3.5mm Cortical Screw, 4.0mm Cancellous Screw,

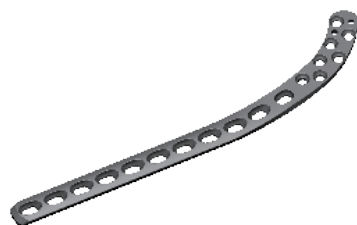

Head thickness    Thickness    Head width    Width  
1.8                    3.5                    40                    10.5

Hole	Direction	P.N	Length	Material
3	Left	122130103	80mm	Titanium
4	Left	122130104	92mm	Titanium
5	Left	122130105	104mm	Titanium
6	Left	122130106	116mm	Titanium
7	Left	122130107	128mm	Titanium
8	Left	122130108	140mm	Titanium
9	Left	122130109	152mm	Titanium
10	Left	122130110	164mm	Titanium
11	Left	122130111	176mm	Titanium
12	Left	122130112	188mm	Titanium
3	Right	122130203	80mm	Titanium
4	Right	122130204	92mm	Titanium
5	Right	122130205	104mm	Titanium
6	Right	122130206	116mm	Titanium
7	Right	122130207	128mm	Titanium
8	Right	122130208	140mm	Titanium
9	Right	122130209	152mm	Titanium
10	Right	122130210	164mm	Titanium
11	Right	122130211	176mm	Titanium
12	Right	122130212	188mm	Titanium

### Small Fragment Plating System SFP Distal Medial Humeral Plate

Matching Screw: 3.5mm Cortical Screw, 4.0mm Cancellous Screw



Head thickness    Thickness    Head width    Width  
1.5                    3.0                    8.2                    8.2

Hole	P.N	Material
10	122133010	Titanium
11	122133011	Titanium
12	122133012	Titanium
13	122133013	Titanium
14	122133014	Titanium
15	122133015	Titanium
16	122133016	Titanium
17	122133017	Titanium
18	122133018	Titanium
19	122133019	Titanium
20	122133020	Titanium

### Small Locking Fragment Plating System SLP Proximal Humeral Locking Plate I

Matching Screw:  
3.5mm Cortical Screw, 4.0mm Cancellous Screw, 3.5mm locking screw



Hole	P.N	Length	Material
3	122238103	90mm	Titanium
4	122238104	102mm	Titanium
5	122238105	114mm	Titanium
6	122238106	126mm	Titanium
7	122238107	138mm	Titanium
8	122238108	150mm	Titanium
9	122238109	162mm	Titanium
10	122238110	174mm	Titanium
11	122238111	186mm	Titanium
12	122238112	198mm	Titanium
13	122238113	210mm	Titanium
14	122238114	222mm	Titanium

## Humerus Plates

### Small Locking Fragment Plating System SLP Proximal Humeral Locking Plate II

Matching Screw:  
3.5mm Cortical Screw, 4.0mm Cancellous Screw, 3.5mm locking screw

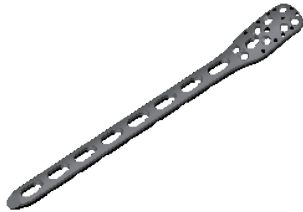

Head thickness    Thickness    Head width    Width  
2                    4.2                22.85        12.5

Hole	P.N	Length	Material
3	122238003	110mm	Titanium
4	122238004	128mm	Titanium
5	122238005	146mm	Titanium
6	122238006	164mm	Titanium
7	122238007	182mm	Titanium
8	122238008	200mm	Titanium
9	122238009	218mm	Titanium
10	122238010	236mm	Titanium
11	122238011	254mm	Titanium
12	122238012	272mm	Titanium
13	122238013	290mm	Titanium

### Small Locking Fragment Plating System SLP Distal Lateral Dorsal Humeral Locking Plate (Buttress)

Matching Screw: 3.5mm Cortical Screw, 4.0mm Cancellous Screw,  
3.5mm locking screw, 3.5mm spacer, 2.4/2.7mm locking screw



Head thickness    Thickness    Head width    Width  
2.5                2.5                23.1            12

Hole	Direction	P.N	Length	Material
3	Left	122243103	65mm	Titanium
5	Left	122243105	91mm	Titanium
7	Left	122243107	117mm	Titanium
9	Left	122243109	143mm	Titanium
14	Right	122243114	208mm	Titanium
3	Right	122243203	65mm	Titanium
5	Right	122243205	91mm	Titanium
7	Right	122243207	117mm	Titanium
9	Right	122243209	143mm	Titanium
14	Right	122243214	208mm	Titanium

### Small Locking Fragment Plating System SLP Distal Medial Humeral Locking Plate

Matching Screw: 3.5mm Cortical Screw, 4.0mm Cancellous Screw,  
3.5mm locking screw, 3.5mm spacer, 2.4/2.7mm locking screw



Head thickness    Thickness    Head width    Width  
3.5                3.5                11                11

Hole	Direction	P.N	Length	Material
3	Left	122238103	59mm	Titanium
5	Left	122245105	84mm	Titanium
7	Left	122245107	110mm	Titanium
9	Left	122245109	136mm	Titanium
14	Left	122245114	201mm	Titanium
3	Right	122245203	59mm	Titanium
5	Right	122245205	84mm	Titanium
7	Right	122245207	110mm	Titanium
9	Right	122245209	136mm	Titanium
14	Right	122245214	201mm	Titanium

## Humerus Plates

### Small Locking Fragment Plating System SLP Proximal Humeral Greater Tubercle Locking Plate

Matching Screw: 3.5mm Cortical Screw, 3.5mm locking Screw, 3.5mm spacer



Hole	Direction	P.N	Length	Material
2	Left	122533102	66	Titanium
3	Left	122533103	78	Titanium
4	Left	122533104	90	Titanium
6	Left	122533106	114	Titanium
8	Left	122533108	138	Titanium
10	Left	122533110	162	Titanium
12	Left	122533112	186	Titanium
14	Left	122533114	210	Titanium
16	Left	122533116	234	Titanium
2	Right	122533202	66	Titanium
3	Right	122533203	78	Titanium
4	Right	122533204	90	Titanium
6	Right	122533206	114	Titanium
8	Right	122533208	138	Titanium
10	Right	122533210	162	Titanium
12	Right	122533212	186	Titanium
14	Right	122533214	210	Titanium
16	Right	122533216	234	Titanium

### Small Locking Fragment Plating System SLP LCP-Distal Humeral extra-articular Locking Plate

Matching Screw: 3.5mm Cortical Screw, 3.5mm locking Screw, 3.5mm spacer



Hole	Direction	P.N	Length	Material
4	Left	122262104	122	Titanium
6	Left	122262106	158	Titanium
8	Left	122262108	194	Titanium
10	Left	122262110	230	Titanium
12	Left	122262112	266	Titanium
14	Left	122262114	302	Titanium
4	Right	122262204	122	Titanium
6	Right	122262206	158	Titanium
8	Right	122262208	194	Titanium
10	Right	122262210	230	Titanium
12	Right	122262212	266	Titanium
14	Right	122262214	302	Titanium

### Small Locking Fragment Plating System SLP Distal Lateral Dorsal Humeral Plate

Matching Screw: 3.5mm Cortical Screw, 4.0mm Cancellous Screw, 3.5mm locking screw, 3.5mm spacer, 2.4/2.7mm locking screw



Hole	Direction	P.N	Length	Material
3	Left	122244103	65mm	Titanium
5	Left	122244105	91mm	Titanium
7	Left	122244107	117mm	Titanium
9	Left	122244109	143mm	Titanium
14	Left	122244114	208mm	Titanium
3	Right	122244203	65mm	Titanium
5	Right	122244205	91mm	Titanium
7	Right	122244207	117mm	Titanium
9	Right	122244209	143mm	Titanium
14	Right	122244214	208mm	Titanium

Head thickness 2.5    Thickness 2.5    Head width 14.2    Width 11

## Humerus Plates

### Small Locking Fragment Plating System SLP LCP-Distal Humeral middle metaphyseal locking plate

Matching Screw: 3.5mm Cortical Screw, 4.0mm Cancellous Screw,  
3.5mm locking screw, 3.5mm spacer



Head thickness 1.4    Thickness 3.2    Head width 11    Width 11.5

Hole	P.N	Length	Material
7	122263007	80mm	Titanium
9	122263009	106mm	Titanium
11	122263011	132mm	Titanium
13	122263013	158mm	Titanium
15	122263015	184mm	Titanium

### Small Fragment Plating System CanSFP Proximal Lateral Humeral Plate, with LC-undercuts

Matching Screw: 3.5mm Cortical Screw, 4.0mm Cancellous Screw,



Head thickness 2.2    Thickness 3.2    Head width 25    Width 11.5

Hole	Direction	P.N	Length	Material
4	Left	122131104	87mm	Titanium
5	Left	122131105	99mm	Titanium
6	Left	122131106	111mm	Titanium
7	Left	122131107	123mm	Titanium
8	Left	122131108	135mm	Titanium
10	Left	122131110	159mm	Titanium
4	Right	122131204	87mm	Titanium
5	Right	122131205	99mm	Titanium
6	Right	122131206	111mm	Titanium
7	Right	122131207	123mm	Titanium
8	Right	122131208	135mm	Titanium
10	Right	122131210	159mm	Titanium

**Radius Plates**

**Small Locking Fragment Plating System SLP  
3.5mm LCP T-Plate, Right-angled( head 4holes)**

Matching Screw: 3.5mm Cortical Screw, 4.0mm Cancellous Screw, 3.5mm locking screw



Head thickness    Thickness    Head width    Width  
1.6                    1.6                    31                    11

Hole	P.N	Length	Material
3	122220003	47mm	Titanium
4	122220004	58mm	Titanium
5	122220005	69mm	Titanium
6	122220006	80mm	Titanium

**Small Locking Fragment Plating System SLP  
3.5mm LCP T-Plate, Oblique-angled( head 3holes)**

Matching Screw: 3.5mm Cortical Screw, 4.0mm Cancellous Screw, 3.5mm locking screw



Head thickness    Thickness    Head width    Width  
1.6                    1.6                    23                    10

Hole	Direction	P.N	Length	Material
3	Left	122221103	52mm	Titanium
4	Left	122221104	63mm	Titanium
5	Left	122221105	74mm	Titanium
3	Right	122221203	52mm	Titanium
4	Right	122221204	63mm	Titanium
5	Right	122221205	74mm	Titanium

**Small Locking Fragment Plating System SLP  
3.5mm LCP T-Plate, Right-angled( head 3holes)**

Matching Screw: 3.5mm Cortical Screw, 4.0mm Cancellous Screw, 3.5mm locking screw



Head thickness    Thickness    Head width    Width  
1.6                    1.6                    24                    10

Hole	P.N	Length	Material
3	122222003	46.5mm	Titanium
4	122222004	57.5mm	Titanium
5	122222005	68.5mm	Titanium
6	122222006	79.5mm	Titanium

**Small Locking Fragment Plating System SLP  
LCP Distal Radius Locking Plate**

Matching screw: 2.4/2.7mm locking screw, 2.4mm Cortical Screw



Hole	P.N	Length	Material
8	122261008	100mm	Titanium
10	122261010	120mm	Titanium
12	122261012	140mm	Titanium

**Radius Plates**

**2.4/2.7 Locking Screw Instruments Set**  
**LCP Proximal Radius Arch(collum radii) Locking Plate**  
Matching Screw: 2.4/2.7mm locking screw, 2.4mm Cortical Screw



Head thickness 1.6    Thickness 1.6    Head width 16    Width 8

Hole	P.N	Length	Material
2	121236002	32mm	Titanium
3	121236003	41mm	Titanium
4	121236004	50mm	Titanium

**2.4/2.7 Locking Screw Instruments Set**  
**LCP Proximal Radius Arch(collum radii) Locking Plate**  
Matching Screw: 2.4/2.7mm locking screw, 2.4mm Cortical Screw



Head thickness 1.6    Thickness 1.6    Head width 15.3    Width 8

Hole	Direction	P.N	Length	Material
2	Left	121237002	37.5mm	Titanium
3	Left	121237003	46.5mm	Titanium
4	Left	121237004	55.5mm	Titanium
2	Right	121237102	37.5mm	Titanium
3	Right	121237103	46.5mm	Titanium
4	Right	121237104	55.5mm	Titanium

**2.4/2.7 Locking Fragment Plating System**  
**LCP Distal Dorsal Radius Locking L-Plate**  
(Head 2 holes)

Matching Screw: 2.4/2.7mm locking screw, 2.4mm Cortical Screw



Hole	Direction	P.N	Length	Material
3	Left	122277103	40mm	Titanium
4	Left	122277104	49mm	Titanium
3	Right	122277203	40mm	Titanium
4	Right	122277204	49mm	Titanium

**2.4/2.7 Locking Fragment Plating System**  
**LCP Distal Dorsal Radius Locking L-Plate**  
(Head 3 holes, Straight)

Matching Screw: 2.4/2.7mm locking Screw, 2.4mm Cortical Screw,



Hole	Direction	P.N	Length	Material
3	Left	122275103	40mm	Titanium
4	Left	122275104	49mm	Titanium
3	Right	122275203	40mm	Titanium
4	Right	122275204	49mm	Titanium

Radius Plates

2.4/2.7 Locking Fragment Plating System  
LCP Distal Dorsal Radius Locking Plate  
( Head 3 holes, Oblique)

Matching Screw:2.4/2.7mm locking Screw,2.4mm Cortical Screw,

Hole	Direction	P.N	Length	Material
3	Left	122276103	43mm	Titanium
4	Left	122276104	52mm	Titanium
3	Right	122276203	43mm	Titanium
4	Right	122276204	52mm	Titanium



2.4/2.7 Locking Fragment Plating System  
LCP Distal Dorsal Radius Locking T-Plate

Matching Screw:2.4/2.7mm locking Screw,2.4mm Cortical Screw,

Hole	P.N	Length	Material
3	122278003	40mm	Titanium
4	122278004	49mm	Titanium



2.4/2.7 Locking Fragment Plating System  
LCP Distal Dorsal Radius Locking T-Plate

Matching Screw:2.4/2.7mm locking Screw,2.4mm Cortical Screw,

Hole	P.N	Length	Material
5	122292005	48mm	Titanium
6	122292006	57mm	Titanium





Radius Plates

**2.4/2.7 Locking Fragment Plating System**  
**VA LCP Distal Palmar Radius two - column Locking Plate**  
( head 6 holes)

Matching Screw:2.4/2.7mm locking Screw,2.4mm VA locking screw,  
2.4mm Cortical Screw



Head thickness    Thickness    Head width    Width  
2.2                    2.2                    22                    7.5

Hole	Direction	P.N	Length	Material
2	Left	122323102	45mm	Titanium
3	Left	122323103	54mm	Titanium
4	Left	122323104	66mm	Titanium
5	Left	122323105	75mm	Titanium
2	Right	122323202	45mm	Titanium
3	Right	122323203	54mm	Titanium
4	Right	122323204	66mm	Titanium
5	Right	122323205	75mm	Titanium

**2.4/2.7 Locking Fragment Plating System**  
**VA LCP Distal Palmar Radius two - column Locking Plate**  
( head 7 holes)

Matching Screw:2.4/2.7mm locking Screw,2.4mm VA locking screw,  
2.4mm Cortical Screw



Hole	Direction	P.N	Length	Material
2	Left	122325102	47mm	Titanium
3	Left	122325103	55mm	Titanium
4	Left	122325104	68mm	Titanium
5	Left	122325105	77mm	Titanium
7	Left	122325107	95mm	Titanium
9	Left	122325109	113mm	Titanium
11	Left	122325111	131mm	Titanium
2	Right	122325202	47mm	Titanium
3	Right	122325203	55mm	Titanium
4	Right	122325204	68mm	Titanium
5	Right	122325205	77mm	Titanium
7	Right	122325207	95mm	Titanium
9	Right	122325209	113mm	Titanium
11	Right	122325211	131mm	Titanium

**2.4/2.7 Locking Fragment Plating System**  
**Distal Radius Volar Locking Plate**

Matching Screw:2.4/2.7mm locking Screw,3.5mm locking screw,  
3.5mm Cortical Screw

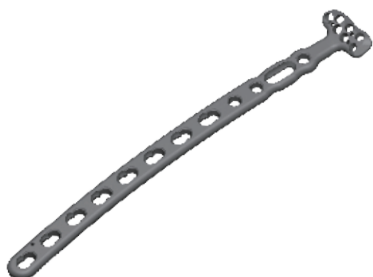

Head thickness    Thickness    Head width    Width  
1.4                    3.2                    11                    11.5

Hole	Direction	P.N	Length	Material
3	Left	121238103	51mm	Titanium
4	Left	121238104	56.6mm	Titanium
7	Left	121238107	89mm	Titanium
10	Left	121238110	140mm	Titanium
12	Left	121238112	175mm	Titanium
3	Right	121238203	51mm	Titanium
4	Right	121238204	56.6mm	Titanium
7	Right	121238207	89mm	Titanium
10	Right	121238210	140mm	Titanium
12	Right	121238212	175mm	Titanium

Ulna Plates

Small Locking Fragment Plating System SLP  
LCP Olecranon Locking Plate

Matching Screw:  
3.5mm Cortical Screw, 4.0mm Cancellous Screw,  
3.5mm locking screw, 3.5mm spacer



Head thickness	Thickness	Head width	Width
2.5	2.5	15	11

Hole	Direction	P.N	Length	Material
2	Left	122240102	86mm	Titanium
4	Left	122240104	112mm	Titanium
6	Left	122240106	138mm	Titanium
8	Left	122240108	163mm	Titanium
10	Left	122240110	190mm	Titanium
12	Left	122240112	216mm	Titanium
2	Right	122240202	86mm	Titanium
4	Right	122240204	112mm	Titanium
6	Right	122240206	138mm	Titanium
8	Right	122240208	163mm	Titanium
10	Right	122240210	190mm	Titanium
12	Right	122240212	216mm	Titanium

Mini Locking Fragment Plating System MLP  
LCP Distal Ulna Hook Locking Plate

Matching Screw:  
2.0mm locking screw, 2.0mm Cortical Screw



Head thickness	Thickness	Head width	Width
/	1.8	5	5

Hole	P.N	Length	Material
7	121235007	46mm	Titanium

## Calcaneus Plates

### Small Fragment Plating System SFP

#### Calcaneal Plate - I

Matching Screw: 3.5mm Cortical Screw, 4.0mm Cancellous Screw SFP



Head thickness    Thickness    Head width    Width  
1.5                    1.5                    41.7            20.5

Hole	P.N	Length	Material
14	122152060	60mm	Titanium
14	122152070	70mm	Titanium

### Small Fragment Plating System SFP

#### Calcaneal Locking Plate-IV

Matching Screw: 3.5mm Cortical Screw, 4.0mm Cancellous Screw



Hole	P.N	Length	Material
8	122156008	48mm	Titanium
10	122156012	58mm	Titanium
12	122156112	65mm	Titanium

### Small Locking Fragment Plating System SLP

#### Calcaneal Locking plate

Matching Screw: 3.5mm Cortical Screw, 4.0mm Cancellous Screw, 3.5mm Locking Screw



Head thickness    Thickness    Head width    Width  
/                    2                    /                    54

Hole	Direction	P.N	Length	Material
15	Left	122234169	69mm	Titanium
15	Left	122234176	76mm	Titanium
15	Right	122234269	69mm	Titanium
15	Right	122234276	76mm	Titanium

### Small Locking Fragment Plating System CanSLP

#### Calcaneal Locking plate

Matching Screw: 3.5mm Cortical Screw, 4.0mm Cancellous Screw, 3.5mm Locking Screw

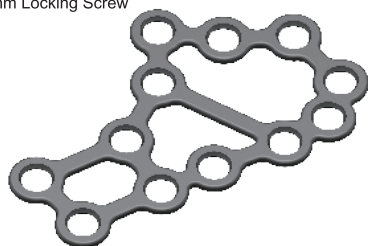

Head thickness    Thickness    Head width    Width  
/                    2                    /                    54

Hole	Direction	P.N	Length	Material
8	Left	122291103	53mm	Titanium
8	Right	122291203	53mm	Titanium
12	Left	122291101	60mm	Titanium
12	Right	122291201	60mm	Titanium
12	Left	122291102	68mm	Titanium
12	Right	122291202	68mm	Titanium

## Femur Plates

Dynamic Hip and Condylar System DHS-DCS  
DHS Plate 135°, with LC-undercuts  
Matching Screw: 4.5mm Cortical Screw, 6.5mm Cancellous Screw



Hole	P.N	Length	Material
2	124111102	52mm	Titanium
3	124111103	68mm	Titanium
4	124111104	84mm	Titanium
5	124111105	100mm	Titanium
6	124111106	116mm	Titanium
8	124111108	148mm	Titanium
10	124111110	180mm	Titanium
12	124111112	212mm	Titanium
14	124111114	244mm	Titanium
16	124111116	276mm	Titanium

Dynamic Hip and Condylar System DHS-DCS  
DHS Plate 95°, with LC-undercuts  
Matching Screw: 4.5mm Cortical Screw, 6.5mm Cancellous Screw



Hole	P.N	Length	Material
4	124113104	117mm	Titanium
6	124113106	149mm	Titanium
8	124113108	181mm	Titanium
10	124113110	213mm	Titanium
12	124113112	245mm	Titanium

Dynamic Hip and Condylar System DHS-DCS  
DHS/DCS Screw, with compression screw



P.N	Length	Material
134115050	50mm	Titanium
134115055	55mm	Titanium
134115060	60mm	Titanium
134115065	65mm	Titanium
134115070	70mm	Titanium
134115075	75mm	Titanium
134115080	80mm	Titanium
134115085	85mm	Titanium
134115090	90mm	Titanium
134115095	95mm	Titanium
134115100	100mm	Titanium
134115105	105mm	Titanium
134115110	110mm	Titanium

Dynamic Hip and Condylar System DHS-DCS  
Lag Screw



P.N	Material
124116000	Titanium

## Femur Plates

### Large Fragment Plating System CanLFP 4.5mm LC-DCP Plate,broad

Matching Screw:4.5mm Cortical Screw,6.5mm Cancellous Screw

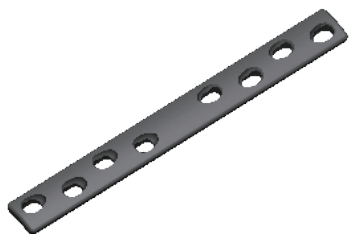

Head thickness    Thickness    Head width    Width  
5.0                5.0                17.5            17.5

Hole	P.N	Length	Material
6	123121006	124mm	Titanium
7	123121007	142mm	Titanium
8	123121008	160mm	Titanium
9	123121009	178mm	Titanium
10	123121010	196mm	Titanium
11	123121011	214mm	Titanium
12	123121012	232mm	Titanium
13	123121013	250mm	Titanium
14	123121014	268mm	Titanium
16	123121016	304mm	Titanium
18	123121018	340mm	Titanium

### Large Fragment Plating System CanLFP Distal Lateral Femoral Plate

Matching Screw:4.5mm Cortical Screw,6.5mm Cancellous Screw



Head thickness    Thickness    Head width    Width  
2.0                5.0                43.8            17

Hole	Direction	P.N	Length	Material
5	Left	123128105	132mm	Titanium
7	Left	123128107	164mm	Titanium
9	Left	123128109	196mm	Titanium
11	Left	123128111	228mm	Titanium
13	Left	123128113	260mm	Titanium
5	Right	123128205	132mm	Titanium
7	Right	123128207	164mm	Titanium
9	Right	123128209	196mm	Titanium
11	Right	123128211	228mm	Titanium
13	Right	123128213	260mm	Titanium

### Large Locking Fragment Plating System LLP 4.5mm Locking Compression Plate(broad, LC-LCP)

Matching Screw:  
4.5mm Cortical Screw, 6.5mm Cancellous Screw, 5.0mm Locking Screw



Head thickness    Thickness    Head width    Width  
2.8                5.2                17.5            17.5

Hole	P.N	Length	Material
5	123221005	98mm	Titanium
6	123221006	116mm	Titanium
7	123221007	134mm	Titanium
8	123221008	152mm	Titanium
9	123221009	170mm	Titanium
10	123221010	188mm	Titanium
11	123221011	206mm	Titanium
12	123221012	224mm	Titanium
13	123221013	242mm	Titanium
14	123221014	260mm	Titanium
15	123221015	278mm	Titanium
16	123221016	296mm	Titanium
17	123221017	314mm	Titanium
18	123221018	332mm	Titanium

### Large Locking Fragment Plating System LLP Distal Lateral Femoral Locking Plate

Matching Screw:  
4.5mm Cortical Screw, 6.5mm Cancellous Screw, 5.0mm Locking Screw



Head thickness    Thickness    Head width    Width  
2.8                5.5                35                16.5

Hole	Direction	P.N	Length	Material
5	Left	123230105	155mm	Titanium
7	Left	123230107	195mm	Titanium
9	Left	123230109	235mm	Titanium
11	Left	123230111	275mm	Titanium
13	Left	123230113	315mm	Titanium
5	Right	123230205	155mm	Titanium
7	Right	123230207	195mm	Titanium
9	Right	123230209	235mm	Titanium
11	Right	123230211	275mm	Titanium
13	Right	123230213	315mm	Titanium

## Femur Plates

### Large Locking Fragment Plating System LLP Distal Lateral Femoral LISS Plate

Matching Screw:  
4.5mm Cortical Screw, 6.5mm Cancellous Screw,  
5.0mm Locking Screw, 5.0mm spacer



Head thickness	Thickness	Head width	Width
2.8	5.5	35	16.5

Hole	Direction	P.N	Length	Material
5	Left	123421105	155mm	Titanium
7	Left	123421107	195mm	Titanium
9	Left	123421109	235mm	Titanium
11	Left	123421111	275mm	Titanium
13	Left	123421113	315mm	Titanium
5	Right	123421205	155mm	Titanium
7	Right	123421207	195mm	Titanium
9	Right	123421209	235mm	Titanium
11	Right	123421211	275mm	Titanium
13	Right	123421213	315mm	Titanium

### Large Locking Fragment Plating System LLP LCP Proximal Femoral Locking Plate

Matching Screw:  
4.5mm Cortical Screw, 6.5mm Cancellous Screw, 5.0mm Locking Screw,  
5.0mm spacer



Head thickness	Thickness	Head width	Width
3.0	5.6	25.4	17.5

Hole	Direction	P.N	Length	Material
4	Left	123228304	175mm	Titanium
6	Left	123228306	211mm	Titanium
8	Left	123228308	247mm	Titanium
10	Left	123228310	283mm	Titanium
12	Left	123228312	319mm	Titanium
4	Right	123228404	175mm	Titanium
6	Right	123228406	211mm	Titanium
8	Right	123228408	247mm	Titanium
10	Right	123228410	283mm	Titanium
12	Right	123228412	319mm	Titanium

Tibia Plates

Small Locking Fragment Plating System CanSLP  
LCP Proximal Medial Tibial Locking Plate

Matching Screw: 3.5mm Cortical Screw, 3.5mm Locking Screw,



Hole	Direction	P.N	Length	Material
4	Left	122266104	60mm	Titanium
6	Left	122266106	84mm	Titanium
8	Left	122166108	108mm	Titanium
4	Right	122166204	60mm	Titanium
6	Right	122166206	84mm	Titanium
8	Right	122266208	108mm	Titanium

Small Locking Fragment Plating System SLP™  
Distal Lateral Tibial Locking Plate

Matching Screw: 3.5mm Cortical Screw, 4.0mm Cancellous Screw, 3.5mm Locking Screw



Head thickness    Thickness    Head width    Width  
2                    3.6                41.5            13.5

Hole	Direction	P.N	Length	Material
5	Left	122235105	80mm	Titanium
7	Left	122235107	106mm	Titanium
9	Left	122235109	132mm	Titanium
11	Left	122235111	158mm	Titanium
13	Left	122235113	184mm	Titanium
15	Left	122235115	210mm	Titanium
17	Left	122235117	236mm	Titanium
19	Left	122235119	262mm	Titanium
21	Left	122235121	288mm	Titanium
5	Right	122235205	80mm	Titanium
7	Right	122235207	106mm	Titanium
9	Right	122235209	132mm	Titanium
11	Right	122235211	158mm	Titanium
13	Right	122235213	184mm	Titanium
15	Right	122235215	210mm	Titanium
17	Right	122235217	236mm	Titanium
19	Right	122235219	262mm	Titanium
21	Right	122235221	288mm	Titanium

Small Locking Fragment Plating System SLP  
3.5mm LCP Distal Medial Tibial Plate

Matching Screw: 3.5mm Cortical Screw    4.0mm Cancellous Screw  
3.5mm Locking Screw



Head thickness    Thickness    Head width    Width  
2.2                4                22.5            11

Hole	Direction	P.N	Length	Material
4	Left	122237104	117mm	Titanium
6	Left	122237106	144mm	Titanium
8	Left	122237108	171mm	Titanium
10	Left	122237110	198mm	Titanium
12	Left	122237112	225mm	Titanium
14	Left	122237114	252mm	Titanium
4	Right	122237204	117mm	Titanium
6	Right	122237206	144mm	Titanium
8	Right	122237208	171mm	Titanium
10	Right	122237210	198mm	Titanium
12	Right	122237212	225mm	Titanium
14	Right	122237214	252mm	Titanium

**Tibia Plates**

**Small Locking Fragment Plating System SLP  
Proximal Lateral Tibial Locking Plate I**

Matching Screw: 3.5mm Cortical Screw, 4.0mm Cancellous Screw,  
3.5mm Locking Screw, 3.5mm Spacer



Head thickness	Thickness	Head width	Width
2.0	3.6	33.5	11

Hole	Direction	P.N	Length	Material
4	Left	122253104	83mm	Titanium
6	Left	122253106	109mm	Titanium
8	Left	122253108	135mm	Titanium
10	Left	122253110	161mm	Titanium
12	Left	122253112	187mm	Titanium
14	Left	122253114	213mm	Titanium
16	Left	122253116	239mm	Titanium
4	Right	122253204	83mm	Titanium
6	Right	122253206	109mm	Titanium
8	Right	122253208	135mm	Titanium
10	Right	122253210	161mm	Titanium
12	Right	122253212	187mm	Titanium
14	Right	122253214	213mm	Titanium
16	Right	122253216	239mm	Titanium

**Small Locking Fragment Plating System SLP  
LCP Distal Medial Tibial Plate**

Matching Screw: 3.5mm Cortical Screw, 4.0mm Cancellous Screw,  
3.5mm Locking Screw, 3.5mm Spacer



Head thickness	Thickness	Head width	Width
2.2	4.2	20.5	11.5

Hole	Direction	P.N	Length	Material
4	Left	122267104	109mm	Titanium
6	Left	122267106	135mm	Titanium
8	Left	122267108	161mm	Titanium
10	Left	122267110	187mm	Titanium
12	Left	122267112	213mm	Titanium
14	Left	122267114	239mm	Titanium
4	Right	122267204	109mm	Titanium
6	Right	122267206	135mm	Titanium
8	Right	122267208	161mm	Titanium
10	Right	122267210	187mm	Titanium
12	Right	122267212	213mm	Titanium
14	Right	122267214	239mm	Titanium

**Small Locking Fragment Plating System CanSLP  
LCP Proximal Posterior Tibial Locking Plate**

Matching Screw: 3.5mm Cortical Screw, 3.5mm Locking Screw,

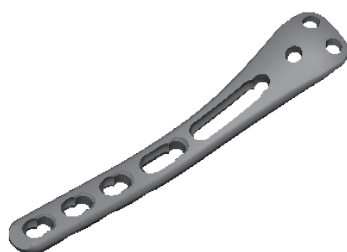

Hole	P.N	Length	Material
1	122255001	69mm	Titanium
2	122255002	79mm	Titanium
4	122255004	105mm	Titanium
6	122255006	131mm	Titanium



Tibia Plates

Large Locking Fragment Plating System LLP  
Proximal Lateral Tibial Locking Plate II

Matching Screw: 4.5mm Cortical Screw,  
6.5mm Cancellous Screw, 5.0mm Locking Screw



Thickness  
2.2      4.2      20.5      11.5

Hole	Direction	P.N	Length	Material
4	Left	123232104	82mm	Titanium
5	Left	123232105	100mm	Titanium
6	Left	123232106	118mm	Titanium
7	Left	123232107	136mm	Titanium
8	Left	123232108	154mm	Titanium
9	Left	123232109	172mm	Titanium
10	Left	123232110	190mm	Titanium
12	Left	123232112	226mm	Titanium
14	Left	123232114	262mm	Titanium
4	Right	123232204	82mm	Titanium
5	Right	123232205	100mm	Titanium
6	Right	123232206	118mm	Titanium
7	Right	123232207	136mm	Titanium
8	Right	123232208	154mm	Titanium
9	Right	123232209	172mm	Titanium
10	Right	123232210	190mm	Titanium
12	Right	123232212	226mm	Titanium
14	Right	123232214	262mm	Titanium

Large Locking Fragment Plating System LLP  
Proximal Tibial Locking Plate

Matching Screw: 4.5mm Cortical Screw,  
6.5mm Cancellous Screw 5.0mm Locking Screw

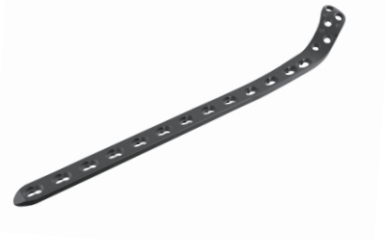

Head thickness    Thickness    Head width    width  
3                    4.8                39.3            15.5

Hole	Direction	P.N	Length	Material
3	Left	123233103	105mm	Titanium
5	Left	123233105	145mm	Titanium
7	Left	123233107	185mm	Titanium
9	Left	123233109	225mm	Titanium
11	Left	123233111	265mm	Titanium
13	Left	123233113	305mm	Titanium
3	Right	123233203	105mm	Titanium
5	Right	123233205	145mm	Titanium
7	Right	123233207	185mm	Titanium
9	Right	123233209	225mm	Titanium
11	Right	123233211	265mm	Titanium
13	Right	123233213	305mm	Titanium

Large Locking Fragment Plating System LLP  
Proximal Lateral Tibial LISS Plate

Matching Screw: 4.5mm Cortical Screw, 6.5mm Cancellous Screw,  
5.0mm Locking Screw, 5.0mm Locking Screw (Self-drilling and self-tapping),  
5.0mm Spacer

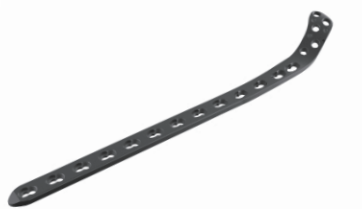

Head thickness    Thickness    Head width    Width  
3                    4.8                21.5            16

Hole	Direction	P.N	Length	Material
5	Left	123420105	141mm	Titanium
7	Left	123420107	181mm	Titanium
9	Left	123420109	221mm	Titanium
11	Left	123420111	261mm	Titanium
13	Left	123420113	301mm	Titanium
5	Right	123420205	141mm	Titanium
7	Right	123420207	181mm	Titanium
9	Right	123420209	221mm	Titanium
11	Right	123420211	261mm	Titanium
13	Right	123420213	301mm	Titanium

Tibia Plates

Large Locking Fragment Plating System LLP  
LCP Proximal Middle Tibial Locking Plate

Matching Screw: 4.5mm Cortical Screw, 6.5mm Cancellous Screw, 5.0mm Locking



Head thickness 1.9    Thickness 3.5    Head width 33    Width 12

Hole	Direction	P.N	Length	Material
4	Left	123247104	106mm	Titanium
6	Left	123247106	142mm	Titanium
8	Left	123247108	178mm	Titanium
10	Left	123247110	214mm	Titanium
12	Left	123247112	250mm	Titanium
14	Left	123247114	286mm	Titanium
16	Left	123247116	322mm	Titanium
4	Right	123247204	106mm	Titanium
6	Right	123247206	142mm	Titanium
8	Right	123247208	178mm	Titanium
10	Right	123247210	214mm	Titanium
12	Right	123247212	250mm	Titanium
14	Right	123247214	286mm	Titanium
16	Right	123247216	322mm	Titanium

Large Locking Fragment Plating System CLLP  
LCP Distal Lateral Tibial Plate

Matching Screw: 4.5mm Cortical Screw, 6.5mm Cancellous Screw



Hole	Direction	P.N	Length	Material
5	Left	123250105	117mm	Titanium
7	Left	123250107	153mm	Titanium
9	Left	123250109	189mm	Titanium
11	Left	123250111	225mm	Titanium
13	Left	123250113	261mm	Titanium
5	Right	123250205	117mm	Titanium
7	Right	123250207	153mm	Titanium
9	Right	123250209	189mm	Titanium
11	Right	123250211	225mm	Titanium
13	Right	123250213	261mm	Titanium

**Fibula Plates**

**Small Locking Fragment Plating System SLP**

**LCP Distal Lateral Fibular Locking Plate**

MatchingScrew:3.5mmCorticalScrew,4.0mmCancellousScrew,  
3.5mmLockingScrew,3.5mmSpacer,2.4/2.7mmLockingScrew



Head thickness    Thickness    Head width    Width  
2.5                    2.5                    14                    9.5

Hole	Direction	P.N	Length	Material
3	Left	122242103	73mm	Titanium
4	Left	122242104	86mm	Titanium
5	Left	122242105	99mm	Titanium
6	Left	122242106	112mm	Titanium
7	Left	122242107	125mm	Titanium
3	Right	122242203	73mm	Titanium
4	Right	122242204	86mm	Titanium
5	Right	122242205	99mm	Titanium
6	Right	122242206	112mm	Titanium
7	Right	122242207	125mm	Titanium

**2.4/2.7 Locking Fragment Plate System**

**LCP Distal Posterior Lateral Fibula Locking Plate**

Matching Screw:2.4mm Locking Screw,2.7mm Locking Screw,  
3.5mm Locking Screw,3.5mm Cortical Screw

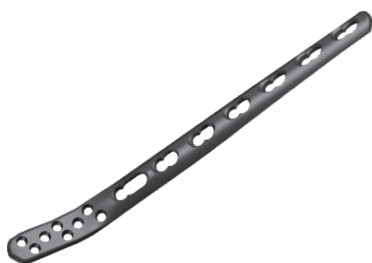

Hole	Direction	P.N	Length	Material
3	Left	122241103	77mm	Titanium
4	Left	122241104	90mm	Titanium
5	Left	122241105	103mm	Titanium
6	Left	122241106	116mm	Titanium
7	Left	122241107	129mm	Titanium
3	Right	122241203	77mm	Titanium
4	Right	122241204	90mm	Titanium
5	Right	122241205	103mm	Titanium
6	Right	122241206	116mm	Titanium
7	Right	122241207	129mm	Titanium

**Pelvis Plates**

**Small Fragment Plating System Can  
3.5mm Reconstruction Plate, curved**

Matching Screw: 3.5mm Cortical Screw, 4.0mm Cancellous Screw



Head thickness    Thickness    Head width    Width  
3.0                    3.0                    10                    10

Hole	P.N	Length	Material
6	122151006	71mm	Titanium
8	122151008	93.5mm	Titanium
10	122151010	115mm	Titanium
12	122151012	135mm	Titanium
14	122151014	154mm	Titanium
16	122151016	171mm	Titanium
18	122151018	186mm	Titanium
20	122151020	199mm	Titanium

**Small Locking Fragment Plating System CanSLP  
Pelvic Reconstruction Locking Plate, curved**

Matching Screw: 3.5mm Cortical Screw,  
4.0mm Cancellous Screw, 3.5mm Locking Screw



Hole	P.N	Material
6	122298006	Titanium
8	122298008	Titanium
10	122298010	Titanium
12	122298012	Titanium
14	122298014	Titanium
16	122298016	Titanium

## Multifunctional Plates

### Small Locking Fragment Plating System SLP LCP 1/3 Tubular Locking Plate

Matching Screw: 3.5mm locking Screw



Head thickness 3.2    Thickness 3.2    Head width 11.5    Width 11.5

Hole	P.N	Length	Material
4	122247004	52mm	Titanium
5	122247005	64mm	Titanium
6	122247006	76mm	Titanium
7	122247007	88mm	Titanium
8	122247008	100mm	Titanium
9	122247009	112mm	Titanium
10	122247010	124mm	Titanium
12	122247012	148mm	Titanium
14	122247014	172mm	Titanium

### Small Locking Fragment Plating System SLP 3.5mm Reconstruction Locking Plate, straight

Matching Screw: 3.5mm Cortical Screw,  
4.0mm Cancellous Screw, 3.5mm Locking Screw



Head thickness 3.2    Thickness 3.2    Head width 10.5    Width 10.5

Hole	P.N	Length	Material
4	122224004	56mm	Titanium
5	122224005	70mm	Titanium
6	122224006	84mm	Titanium
7	122224007	98mm	Titanium
8	122224008	112mm	Titanium
9	122224009	126mm	Titanium
10	122224010	140mm	Titanium
11	122224011	154mm	Titanium
12	122224012	168mm	Titanium
13	122224013	182mm	Titanium
14	122224014	196mm	Titanium
16	122224016	224mm	Titanium
18	122224018	252mm	Titanium
20	122224020	280mm	Titanium
22	122224022	308mm	Titanium

### Small Locking Fragment Plating System SLP 3.5mm Locking Compression Plate(narrow, LC-LCP)

Matching Screw: 3.5mm Cortical Screw,  
4.0mm Cancellous Screw, 3.5mm Locking Screw



Head thickness 3.2    Thickness 3.2    Head width 11.5    Width 11.5

Hole	P.N	Length	Material
4	122226004	59mm	Titanium
5	122226005	72mm	Titanium
6	122226006	85mm	Titanium
7	122226007	98mm	Titanium
8	122226008	111mm	Titanium
9	122226009	124mm	Titanium
10	122226010	137mm	Titanium
11	122226011	150mm	Titanium
12	122226012	163mm	Titanium

### Small Locking Fragment Plating System SLP 3.5mm Metaphysis Locking Plate

Matching Screw: 3.5mm Cortical Screw, 4.0mm Cancellous Screw,  
3.5mm Locking Screw, 3.5mm Spacer



Head thickness 3.2    Thickness 3.2    Head width 11.5    Width 11.5

Hole	P.N	Length	Material
6	122246006	86mm	Titanium
7	122246007	99mm	Titanium
8	122246008	112mm	Titanium
9	122246009	125mm	Titanium
10	122246010	138mm	Titanium
11	122246011	151mm	Titanium
12	122246012	164mm	Titanium
14	122246014	190mm	Titanium
16	122246016	216mm	Titanium
18	122246018	242mm	Titanium

## Multifunctional Plates

### Small Locking Fragment Plating System SLP LCP Hook Locking Plate

Matching Screw: 3.5mm Cortical Screw,  
4.0mm Cancellous Screw, 3.5mm Locking Screw



Head thickness / Thickness Head width Width  
/ 1.6 11 11

Hole	P.N	Length	Material
3	122239003	62mm	Titanium
4	122239004	80mm	Titanium
5	122239005	98mm	Titanium

### Large Locking Fragment Plating System LLP 4.5mm Locking Compression Plate(narrow, LC-LCP)

Matching Screw: 4.5mm Cortical Screw,  
6.5mm Cancellous Screw 5.0mm Locking Screw



Head thickness Thickness Head width Width  
2.8 4.8 13.5 13.5

Hole	P.N	Length	Material
5	123222005	98mm	Titanium
6	123222006	116mm	Titanium
7	123222007	134mm	Titanium
8	123222008	152mm	Titanium
9	123222009	170mm	Titanium
10	123222010	188mm	Titanium
11	123222011	206mm	Titanium
12	123222012	224mm	Titanium
13	123222013	242mm	Titanium
14	123222014	260mm	Titanium
15	123222015	278mm	Titanium
16	123222016	296mm	Titanium

### Large Locking Fragment Plating System LLP 3.5/4.5mm Metaphysis Locking Plate

Matching Screw: 3.5mm Cortical Screw, 4.0mm Cancellous Screw,  
3.5mm Locking Screw, 4.5mm Cortical Screw, 6.5 mm Cancellous Screw,  
5.0mm Locking Screw



Head thickness Thickness Head width Width  
2.3 4.8 / 13.5

Hole	P.N	Length	Material
3	123220003	118mm	Titanium
4	123220004	136mm	Titanium
5	123220005	154mm	Titanium
6	123220006	172mm	Titanium
7	123220007	190mm	Titanium
8	123220008	208mm	Titanium
9	123220009	226mm	Titanium
11	123220011	262mm	Titanium
13	123220013	298mm	Titanium
15	123220015	334mm	Titanium

Mini Plates

Mini Fragment Plating System MFP  
2.0mm T-Plate(head 3 holes)

Matching Screw:2.0mm Cortex Screw



Head thickness    Thickness    Head width    Width  
0.8                0.8                16.2            5

Hole	P.N	Length	Material
4	121133004	29.5mm	Titanium
5	121133005	29.5mm	Titanium
6	121133006	42mm	Titanium
7	121133007	42mm	Titanium
8	121133008	54.5mm	Titanium

Mini Fragment Plating System MFP  
2.0mm Tubular Plate

Matching Screw:2.0mm Cortex Screw



Head thickness    Thickness    Head width    Width  
1.2                1.2                5.5                5.5

Hole	P.N	Length	Material
2	121121002	11mm	Titanium
3	121121003	17mm	Titanium
4	121121004	23mm	Titanium
5	121121005	29mm	Titanium
6	121121006	35mm	Titanium
7	121121007	41mm	Titanium

Mini Fragment Plating System MFP  
2.4mm Reconstruction Plate

Matching Screw:2.4mm Cortex Screw



Head thickness    Thickness    Head width    Width  
1.6                1.6                6.5                6.5

Hole	P.N	Length	Material
4	121120004	25.5mm	Titanium
5	121120005	32.0mm	Titanium
6	121120006	38.5mm	Titanium

Mini Fragment Plating System MFP  
2.5mm T-Plate

Matching Screw:2.4mm Cortex Screw



Head thickness    Thickness    Head width    Width  
1.2                1.6                13                5.5

Hole	P.N	Length	Material
2	121130002	19mm	Titanium
3	121130003	28mm	Titanium
4	121130004	36mm	Titanium
5	121130005	43mm	Titanium

Mini Plates

Mini Fragment Plating System MFP

2.0mm T-Plate

Matching Screw: 2.0mm Cortex Screw



Head thickness    Thickness    Head width    Width  
0.8                    0.8                    10.92            5.5

Hole	P.N	Length	Material
2	121130102	19mm	Titanium
3	121130103	28mm	Titanium
4	121130104	36mm	Titanium
5	121130105	36mm	Titanium

Mini Fragment Plating System MFP

2.0mm T-Plate

Matching Screw: 2.0mm Cortex Screw



Head thickness    Thickness    Head width    Width  
0.8                    0.8                    10.8            5.5

Hole	Direction	P.N	Length	Material
4	Left	121131004	19mm	Titanium
5	Right	121131005	25mm	Titanium
4	Left	121131104	19mm	Titanium
5	Right	121131105	25mm	Titanium

Mini Locking Fragment Plating System MLP

LCP Mini Locking Plate(Y-shape)

Matching Screw: 2.4mm Locking Screw



Head thickness    Thickness    Head width    Width  
1.3                    1.8                    19.2            6.5

Hole	P.N	Length	Material
4	121233004	38.2mm	Titanium
5	121233005	45.5mm	Titanium
6	121233006	52.7mm	Titanium
7	121233007	60mm	Titanium

Mini Fragment Plating System MLP

LCP Mini Locking Plate(T-shape)

Matching Screw: 2.4mm Locking Screw



Head thickness    Thickness    Head width    Width  
1.3                    1.8                    19.2            6.5

Hole	P.N	Length	Material
4	121234004	35.2mm	Titanium
5	121234005	42.5mm	Titanium
6	121234006	49.7mm	Titanium
7	121234007	57mm	Titanium



Mini Plates

Mini Fragment Plating System MLP  
2.0mm LCP Y-Plate

Matching Screw: 2.0mm Locking Screw



Head thickness 1.3    Thickness 1.8    Head width 17.5    Width 5

Hole	P.N	Length	Material
4	121233104	38.2mm	Titanium
5	121233105	45.5mm	Titanium
6	121233106	52.7mm	Titanium
7	121233107	60.0mm	Titanium

Mini Locking Fragment Plating System MLP  
2.0mm LCP T-Plate

Matching Screw: 2.0mm Locking Screw



Head thickness 1.3    Thickness 1.8    Head width 18    Width 5

Hole	P.N	Length	Material
4	121234104	35.2mm	Titanium
5	121234105	42.5mm	Titanium
6	121234106	49.7mm	Titanium
7	121234107	57.0mm	Titanium

Mini Fragment Plating System MLP  
2.0mm LCP Condylar Plate

Matching Screw: 2.0mm Locking Screw



Head thickness 1.3    Thickness 1.8    Head width 10    Width 5

Hole	P.N	Length	Material
3	121224103	30.0mm	Titanium
4	121224104	37.5mm	Titanium
5	121224105	44.5mm	Titanium
6	121224106	51.7mm	Titanium
7	121224107	59.0mm	Titanium

Mini Fragment Plating System MLP  
LCP Locking Plate

Matching Screw: 2.0mm Locking Screw



Head thickness 1.3    Thickness 1.3    Head width 5.5    Width 5.5

Hole	P.N	Length	Material
4	121222104	36mm	Titanium
5	121222105	36mm	Titanium
6	121222106	44mm	Titanium
7	121222107	52mm	Titanium
8	121222108	60mm	Titanium
10	121222110	68mm	Titanium

Mini Plates

**Mini Locking Fragment Plating System MLP**  
**LCP Adaption Locking Plate**  
Matching Screw:2.0mm Locking Screw



Head thickness Thickness Head width Width  
1.3 1.3 5 5

Hole	P.N	Length	Material
12	121223112	88m	Titanium

**Mini Fragment Plating System MLP**  
**2.4mm LCP Condylar Plate**  
Matching Screw:2.4mm Locking Screw



Head thickness Thickness Head width Width  
1.3 1.8 12 6.5

Hole	P.N	Length	Material
3	121224003	30.0mm	Titanium
4	121224004	37.5mm	Titanium
5	121224005	44.5mm	Titanium
6	121224006	51.7mm	Titanium
7	121224007	59.0mm	Titanium

**Mini Fragment Plating System MLP**  
**Locking Plate**  
Matching Screw:2.4mm Locking Screw



Head thickness Thickness Head width Width  
1.6 1.6 6.5 6.5

Hole	P.N	Length	Material
4	121222004	36mm	Titanium
5	121222005	44mm	Titanium
6	121222006	52mm	Titanium
7	121222007	60mm	Titanium
8	121222008	68mm	Titanium
10	121222010	84mm	Titanium

**Mini Locking Fragment Plating System MLP**  
**LCP Adaption Locking Plate**  
Matching Screw:2.4mm Locking Screw



Head thickness Thickness Head width Width  
1.8 1.8 6.5 6.5

Hole	P.N	Length	Material
12	121223012	88mm	Titanium

**Mini Plates**

**Mini Fragment Plating System MLP  
1.5mm Locking T-Plate**

Matching Screw: 1.5mm locking Screw, 1.5mm Cortical Screw



Hole	P.N	Length	Material
4	121131004	26mm	Titanium
5	121131005	31mm	Titanium
6	121131006	36mm	Titanium
7	121131007	41mm	Titanium
8	121131008	46mm	Titanium

**Mini Fragment Plating System MLP  
1.5mm Locking Y-Plate**

Matching Screw: 1.5mm locking Screw, 1.5mm Cortical Screw



Hole	P.N	Length	Material
4	121240004	27.4mm	Titanium
5	121240005	32.4mm	Titanium
6	121240006	37.4mm	Titanium
7	121240007	42.4mm	Titanium
8	121240008	47.4mm	Titanium

**Mini Fragment Plating System MLP  
1.5mm Locking Condylar Plate**

Matching Screw 1.5mm locking Screw, 1.5mm Cortical Screw



Hole	P.N	Length	Material
4	121241004	27.4mm	Titanium
5	121241005	32.4mm	Titanium
6	121241006	37.4mm	Titanium
7	121241007	42.4mm	Titanium

**Mini Locking Fragment Plating System CanMLP  
1.5mm Locking Support Plate**

Matching Screw: 1.5mm Locking Screw, 1.5mm Cortical Screw



Hole	Direction	P.N	Length	Material
8	Left	121239108	23mm	Titanium
8	Right	121239208	23mm	Titanium

**Mini plates**

**Mini Fragment Plating System MLP  
1.5mm Phalangeal Metacarpal Plate**

Matching Screw: 1.5mm locking Screw, 1.5mm Cortical Screw



Hole	P.N	Length	Material
6	121221006	30.5mm	Titanium
12	121221012	60.5mm	Titanium

**Mini Locking Fragment Plating System CanMLP  
1.5mm LCP Locking Plate**

Matching Screw: 1.5mm Locking Screw, 1.5mm Cortical Screw



Hole	P.N	Length	Material
4	121222204	25mm	Titanium
5	121222205	38mm	Titanium
6	121222206	51mm	Titanium
7	121222207	38mm	Titanium
8	121222208	51mm	Titanium
10	121222210	51mm	Titanium

**Screws**

Mini Fragment Plating System MFP  
Cortex Screw  $\Phi$ 1.5mm



Specification	P.N	Material
$\Phi$ 1.5x6	131116006	Titanium
$\Phi$ 1.5x7	131116007	Titanium
$\Phi$ 1.5x8	131116008	Titanium
$\Phi$ 1.5x9	131116009	Titanium
$\Phi$ 1.5x10	131116010	Titanium
$\Phi$ 1.5x11	131116011	Titanium
$\Phi$ 1.5x12	131116012	Titanium
$\Phi$ 1.5x13	131116013	Titanium
$\Phi$ 1.5x14	131116014	Titanium
$\Phi$ 1.5x16	131116016	Titanium
$\Phi$ 1.5x18	131116018	Titanium
$\Phi$ 1.5x20	131116020	Titanium

Mini Fragment Plating System MFP  
Cortex Screw  $\Phi$ 2.0mm



Thread diameter	Depth	Spacing	Shank diameter
$\Phi$ 2.0	0.3	0.6	$\Phi$ 1.4
Head diameter	Head height		
$\Phi$ 3.2	1		

Specification	P.N	Material
$\Phi$ 2.0x7	131114007	Titanium
$\Phi$ 2.0x8	131114008	Titanium
$\Phi$ 2.0x9	131114009	Titanium
$\Phi$ 2.0x10	131114010	Titanium
$\Phi$ 2.0x11	131114011	Titanium
$\Phi$ 2.0x12	131114012	Titanium
$\Phi$ 2.0x13	131114013	Titanium
$\Phi$ 2.0x14	131114014	Titanium
$\Phi$ 2.0x16	131114016	Titanium
$\Phi$ 2.0x18	131114018	Titanium
$\Phi$ 2.0x20	131114020	Titanium
$\Phi$ 2.0x22	131114022	Titanium
$\Phi$ 2.0x24	131114024	Titanium
$\Phi$ 2.0x26	131114026	Titanium
$\Phi$ 2.0x28	131114028	Titanium
$\Phi$ 2.0x30	131114030	Titanium
$\Phi$ 2.0x32	131114032	Titanium
$\Phi$ 2.0x34	131114034	Titanium
$\Phi$ 2.0x36	131114036	Titanium
$\Phi$ 2.0x38	131114038	Titanium

Mini Fragment Plating System MFP  
Cortex Screw  $\Phi$ 2.4mm



Thread diameter	Depth	Spacing	Shank diameter
$\Phi$ 2.4	0.32	1	$\Phi$ 1.7
Head diameter	Head height		
$\Phi$ 3.6	1.2		

Specification	P.N	Material
$\Phi$ 2.4x8	132103008	Titanium
$\Phi$ 2.4x10	132103010	Titanium
$\Phi$ 2.4x11	132103011	Titanium
$\Phi$ 2.4x12	132103012	Titanium
$\Phi$ 2.4x13	132103013	Titanium
$\Phi$ 2.4x14	132103014	Titanium
$\Phi$ 2.4x16	132103016	Titanium
$\Phi$ 2.4x18	132103018	Titanium
$\Phi$ 2.4x20	132103020	Titanium
$\Phi$ 2.4x22	132103022	Titanium
$\Phi$ 2.4x24	132103024	Titanium
$\Phi$ 2.4x26	132103026	Titanium
$\Phi$ 2.4x28	132103028	Titanium
$\Phi$ 2.4x30	132103030	Titanium
$\Phi$ 2.4x32	132103032	Titanium
$\Phi$ 2.4x34	132103034	Titanium
$\Phi$ 2.4x36	132103036	Titanium
$\Phi$ 2.4x38	132103038	Titanium
$\Phi$ 2.4x40	132103040	Titanium

**Screws**

**Mini Fragment Plating System MFP  
Cortex Screw  $\Phi$ 2.0mm**



Thread diameter	Depth	Spacing	Shank diameter
$\Phi$ 2.0	0.3	0.6	$\Phi$ 1.4
Head diameter	Head height		
$\Phi$ 3.2	0.92		

Specification	P.N	Material
$\Phi$ 2.0x6	131115006	Titanium
$\Phi$ 2.0x7	131115007	Titanium
$\Phi$ 2.0x8	131115008	Titanium
$\Phi$ 2.0x9	131115009	Titanium
$\Phi$ 2.0x10	131115010	Titanium
$\Phi$ 2.0x11	131115011	Titanium
$\Phi$ 2.0x12	131115012	Titanium
$\Phi$ 2.0x13	131115013	Titanium
$\Phi$ 2.0x14	131115014	Titanium
$\Phi$ 2.0x16	131115016	Titanium
$\Phi$ 2.0x18	131115018	Titanium
$\Phi$ 2.0x20	131115020	Titanium
$\Phi$ 2.0x22	131115022	Titanium
$\Phi$ 2.0x24	131115024	Titanium
$\Phi$ 2.0x26	131115026	Titanium
$\Phi$ 2.0x28	131115028	Titanium
$\Phi$ 2.0x30	131115030	Titanium
$\Phi$ 2.0x32	131115032	Titanium
$\Phi$ 2.0x34	131115034	Titanium
$\Phi$ 2.0x36	131115036	Titanium
$\Phi$ 2.0x38	131115038	Titanium

**Large Fragment Plating System MFP  
Cortex Screw  $\Phi$ 2.4mm**



Thread diameter	Depth	Spacing	Shank diameter
$\Phi$ 2.4	0.32	1	$\Phi$ 1.7
Head diameter	Head height		
$\Phi$ 4.0	1.8		

Specification	P.N	Material
$\Phi$ 2.4x8	132105008	Titanium
$\Phi$ 2.4x10	132105010	Titanium
$\Phi$ 2.4x11	132105011	Titanium
$\Phi$ 2.4x12	132105012	Titanium
$\Phi$ 2.4x13	132105013	Titanium
$\Phi$ 2.4x14	132105014	Titanium
$\Phi$ 2.4x16	132105016	Titanium
$\Phi$ 2.4x18	132105018	Titanium
$\Phi$ 2.4x20	132105020	Titanium
$\Phi$ 2.4x22	132105022	Titanium
$\Phi$ 2.4x24	132105024	Titanium
$\Phi$ 2.4x26	132105026	Titanium
$\Phi$ 2.4x28	132105028	Titanium
$\Phi$ 2.4x30	132105030	Titanium
$\Phi$ 2.4x32	132105032	Titanium
$\Phi$ 2.4x34	132105034	Titanium
$\Phi$ 2.4x36	132105036	Titanium
$\Phi$ 2.4x38	132105038	Titanium
$\Phi$ 2.4x40	132105040	Titanium
$\Phi$ 2.4x60	132105060	Titanium

## Screws

### Small Fragment Plating System SFP Cortex Screw 3.5mm

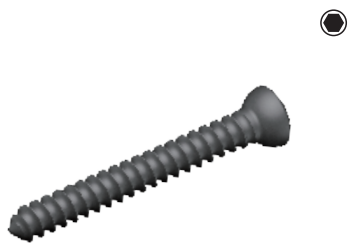

Thread diameter	Depth	Spacing	Shank diameter
Φ3.5	0.55	1.25	Φ2.4

Head diameter	Head height	Head specifications(Unit:mm)
Φ6	3.2	2.5

Specification	P.N	Material
Φ3.5x12	132111012	Titanium
Φ3.5x14	132111014	Titanium
Φ3.5x16	132111016	Titanium
Φ3.5x18	132111018	Titanium
Φ3.5x20	132111020	Titanium
Φ3.5x22	132111022	Titanium
Φ3.5x24	132111024	Titanium
Φ3.5x26	132111026	Titanium
Φ3.5x28	132111028	Titanium
Φ3.5x30	132111030	Titanium
Φ3.5x32	132111032	Titanium
Φ3.5x34	132111034	Titanium
Φ3.5x36	132111036	Titanium
Φ3.5x38	132111038	Titanium
Φ3.5x40	132111040	Titanium
Φ3.5x42	132111042	Titanium
Φ3.5x44	132111044	Titanium
Φ3.5x46	132111046	Titanium
Φ3.5x48	132111048	Titanium
Φ3.5x50	132111050	Titanium
Φ3.5x55	132111055	Titanium
Φ3.5x60	132111060	Titanium
Φ3.5x65	132111065	Titanium
Φ3.5x70	132111070	Titanium
Φ3.5x75	132111075	Titanium
Φ3.5x80	132111080	Titanium
Φ3.5x85	132111085	Titanium
Φ3.5x90	132111090	Titanium

### Small Fragment Plating System SFP Cortex Screw, Self-tapping Φ3.5mm

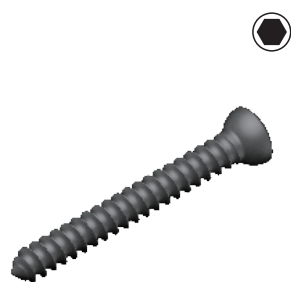

Thread diameter	Depth	Spacing	Shank diameter
Φ3.5	0.55	1.25	Φ2.4

Head diameter	Head height
Φ6.0	2.7

Specification	P.N	Material
Φ3.5x12	132112012	Titanium
Φ3.5x14	132112014	Titanium
Φ3.5x16	132112016	Titanium
Φ3.5x18	132112018	Titanium
Φ3.5x20	132112020	Titanium
Φ3.5x22	132112022	Titanium
Φ3.5x24	132112024	Titanium
Φ3.5x26	132112026	Titanium
Φ3.5x28	132112028	Titanium
Φ3.5x30	132112030	Titanium
Φ3.5x32	132112032	Titanium
Φ3.5x34	132112034	Titanium
Φ3.5x36	132112036	Titanium
Φ3.5x38	132112038	Titanium
Φ3.5x40	132112040	Titanium
Φ3.5x42	132112042	Titanium
Φ3.5x44	132112044	Titanium
Φ3.5x46	132112046	Titanium
Φ3.5x48	132112048	Titanium
Φ3.5x50	132112050	Titanium

## Screws

### Small Fragment Plating System SFP

Cancellous Bone Screw, fully threaded  $\Phi 4.0\text{mm}$



Thread diameter	Depth	Spacing	Shank diameter	Head diameter
$\Phi 4$	1.05	1.75	$\Phi 1.9$	$\Phi 6$

Head height	Head specifications(Unit:mm)
3.2	2.5

Specification	P.N	Material
$\Phi 4.0 \times 12$	132117212	Titanium
$\Phi 4.0 \times 14$	132117214	Titanium
$\Phi 4.0 \times 16$	132117216	Titanium
$\Phi 4.0 \times 18$	132117218	Titanium
$\Phi 4.0 \times 20$	132117220	Titanium
$\Phi 4.0 \times 22$	132117222	Titanium
$\Phi 4.0 \times 24$	132117224	Titanium
$\Phi 4.0 \times 26$	132117226	Titanium
$\Phi 4.0 \times 28$	132117228	Titanium
$\Phi 4.0 \times 30$	132117230	Titanium
$\Phi 4.0 \times 32$	132117232	Titanium
$\Phi 4.0 \times 34$	132117234	Titanium
$\Phi 4.0 \times 36$	132117236	Titanium
$\Phi 4.0 \times 38$	132117238	Titanium
$\Phi 4.0 \times 40$	132117240	Titanium
$\Phi 4.0 \times 42$	132117242	Titanium
$\Phi 4.0 \times 44$	132117244	Titanium
$\Phi 4.0 \times 46$	132117246	Titanium
$\Phi 4.0 \times 48$	132117248	Titanium
$\Phi 4.0 \times 50$	132117250	Titanium
$\Phi 4.0 \times 52$	132117252	Titanium

### Small Fragment Plating System SFP

Cancellous Bone Screw, partially threaded  $\Phi 4.0\text{mm}$



Thread diameter	Depth	Spacing	Shank diameter	Head diameter
$\Phi 4$	1.05	1.75	$\Phi 1.9$	$\Phi 6$

Head height	Head specifications(Unit:mm)
3.2	2.5

Specification	P.N	Material
$\Phi 4.0 \times 20$	132115020	Titanium
$\Phi 4.0 \times 22$	132115022	Titanium
$\Phi 4.0 \times 24$	132115024	Titanium
$\Phi 4.0 \times 26$	132115026	Titanium
$\Phi 4.0 \times 28$	132115028	Titanium
$\Phi 4.0 \times 30$	132115030	Titanium
$\Phi 4.0 \times 32$	132115032	Titanium
$\Phi 4.0 \times 34$	132115034	Titanium
$\Phi 4.0 \times 36$	132115036	Titanium
$\Phi 4.0 \times 38$	132115038	Titanium
$\Phi 4.0 \times 40$	132115040	Titanium
$\Phi 4.0 \times 42$	132115042	Titanium
$\Phi 4.0 \times 44$	132115044	Titanium
$\Phi 4.0 \times 46$	132115046	Titanium
$\Phi 4.0 \times 48$	132115048	Titanium
$\Phi 4.0 \times 50$	132115050	Titanium
$\Phi 4.0 \times 52$	132115052	Titanium
$\Phi 4.0 \times 54$	132115054	Titanium
$\Phi 4.0 \times 56$	132115056	Titanium
$\Phi 4.0 \times 58$	132115058	Titanium
$\Phi 4.0 \times 60$	132115060	Titanium

### Large Fragment Plating System LFP

Cancellous Bone Screw  $\Phi 6.5\text{mm}$ , partially threaded



Specification	P.N	Material
$\Phi 6.5 \times 50$	133115050	Titanium
$\Phi 6.5 \times 55$	133115055	Titanium
$\Phi 6.5 \times 60$	133115060	Titanium
$\Phi 6.5 \times 65$	133115065	Titanium
$\Phi 6.5 \times 70$	133115070	Titanium
$\Phi 6.5 \times 75$	133115075	Titanium
$\Phi 6.5 \times 80$	133115080	Titanium
$\Phi 6.5 \times 85$	133115085	Titanium
$\Phi 6.5 \times 90$	133115090	Titanium
$\Phi 6.5 \times 95$	133115095	Titanium
$\Phi 6.5 \times 100$	133115100	Titanium
$\Phi 6.5 \times 105$	133115105	Titanium
$\Phi 6.5 \times 110$	133115110	Titanium
$\Phi 6.5 \times 115$	133115115	Titanium
$\Phi 6.5 \times 120$	133115120	Titanium



**Screws**

**Large Fragment Plating System LFP  
Cortex Screw  $\Phi$ 4.5mm**



Thread diameter	Depth	Spacing	Shank diameter	Head diameter
$\Phi$ 4.5	0.75	1.75	$\Phi$ 3	$\Phi$ 8

Head height	Head specifications(Unit:mm)
4.5	3.5

Specification	P.N	Material
$\Phi$ 4.5X16	133111016	Titanium
$\Phi$ 4.5X18	133111018	Titanium
$\Phi$ 4.5X20	133111020	Titanium
$\Phi$ 4.5X22	133111022	Titanium
$\Phi$ 4.5X24	133111024	Titanium
$\Phi$ 4.5X26	133111026	Titanium
$\Phi$ 4.5X28	133111028	Titanium
$\Phi$ 4.5X30	133111030	Titanium
$\Phi$ 4.5X32	133111032	Titanium
$\Phi$ 4.5X34	133111034	Titanium
$\Phi$ 4.5X36	133111036	Titanium
$\Phi$ 4.5X38	133111038	Titanium
$\Phi$ 4.5X40	133111040	Titanium
$\Phi$ 4.5X42	133111042	Titanium
$\Phi$ 4.5X44	133111044	Titanium
$\Phi$ 4.5X46	133111046	Titanium
$\Phi$ 4.5X48	133111048	Titanium
$\Phi$ 4.5X50	133111050	Titanium
$\Phi$ 4.5X52	133111052	Titanium
$\Phi$ 4.5X54	133111054	Titanium
$\Phi$ 4.5X56	133111056	Titanium
$\Phi$ 4.5X58	133111058	Titanium
$\Phi$ 4.5X60	133111060	Titanium
$\Phi$ 4.5 $\times$ 65	133111065	Titanium
$\Phi$ 4.5 $\times$ 70	133111070	Titanium
$\Phi$ 4.5 $\times$ 75	133111075	Titanium
$\Phi$ 4.5 $\times$ 80	133111080	Titanium
$\Phi$ 4.5 $\times$ 85	133111085	Titanium
$\Phi$ 4.5 $\times$ 90	133111090	Titanium

**Large Fragment Plating System LFP  
Cancellous Bone Screw  $\Phi$ 6.5mm, fully threaded**



Thread diameter	Depth	Spacing	Shank diameter	Head diameter
$\Phi$ 6.5	1.75	2.75	$\Phi$ 3	$\Phi$ 8

Head height	Head specifications(Unit:mm)
4.8	3.5

Specification	P.N	Material
$\Phi$ 6.5X20	133117020	Titanium
$\Phi$ 6.5X25	133117025	Titanium
$\Phi$ 6.5X30	133117030	Titanium
$\Phi$ 6.5X35	133117035	Titanium
$\Phi$ 6.5X40	133117040	Titanium
$\Phi$ 6.5X45	133117045	Titanium
$\Phi$ 6.5X50	133117050	Titanium
$\Phi$ 6.5X55	133117055	Titanium
$\Phi$ 6.5X60	133117060	Titanium
$\Phi$ 6.5X65	133117065	Titanium
$\Phi$ 6.5X70	133117070	Titanium
$\Phi$ 6.5X75	133117075	Titanium
$\Phi$ 6.5X80	133117080	Titanium
$\Phi$ 6.5X85	133117085	Titanium
$\Phi$ 6.5X90	133117090	Titanium
$\Phi$ 6.5X95	133117095	Titanium
$\Phi$ 6.5X100	133117100	Titanium
$\Phi$ 6.5X105	133117105	Titanium
$\Phi$ 6.5X110	133117110	Titanium
$\Phi$ 6.5X115	133117115	Titanium
$\Phi$ 6.5X120	133117120	Titanium

**Screws**

Mini Fragment Plating System MLP  
Locking Screw  $\Phi$ 1.5mm



Specification	P.N	Material
$\Phi$ 1.5x6	131216006	Titanium
$\Phi$ 1.5x7	131216007	Titanium
$\Phi$ 1.5x8	131216008	Titanium
$\Phi$ 1.5x9	131216009	Titanium
$\Phi$ 1.5x10	131216010	Titanium
$\Phi$ 1.5x11	131216011	Titanium
$\Phi$ 1.5x12	131216012	Titanium
$\Phi$ 1.5x13	131216013	Titanium
$\Phi$ 1.5x14	131216014	Titanium
$\Phi$ 1.5x16	131216016	Titanium
$\Phi$ 1.5x18	131216018	Titanium
$\Phi$ 1.5x20	131216020	Titanium

Mini Locking Fragment Plating System MLP  
Locking screw, self-tapping  $\Phi$ 2.0mm



Thread diameter	Depth	Spacing	Shank diameter	Head diameter
$\Phi$ 2	0.3	0.6	$\Phi$ 1.4	$\Phi$ 2.8
Head height	Head specifications(Unit:mm)			
1.8	/			

Specification	P.N	Material
$\Phi$ 2.0x6	131212006	Titanium
$\Phi$ 2.0x7	131212007	Titanium
$\Phi$ 2.0x8	131212008	Titanium
$\Phi$ 2.0x9	131212009	Titanium
$\Phi$ 2.0x10	131212010	Titanium
$\Phi$ 2.0x11	131212011	Titanium
$\Phi$ 2.0x12	131212012	Titanium
$\Phi$ 2.0x13	131212013	Titanium
$\Phi$ 2.0x14	131212014	Titanium
$\Phi$ 2.0x16	131212016	Titanium
$\Phi$ 2.0x18	131212018	Titanium
$\Phi$ 2.0x20	131212020	Titanium
$\Phi$ 2.0x22	131212022	Titanium
$\Phi$ 2.0x24	131212024	Titanium
$\Phi$ 2.0x26	131212026	Titanium
$\Phi$ 2.0x28	131212028	Titanium
$\Phi$ 2.0x30	131212030	Titanium

Small Locking Fragment Plating System SLP  
VA Locking Screw  $\Phi$ 2.4mm



Specification	P.N	Material
$\Phi$ 2.4X8	132311008	Titanium
$\Phi$ 2.4X10	132311010	Titanium
$\Phi$ 2.4X12	132311012	Titanium
$\Phi$ 2.4X14	132311014	Titanium
$\Phi$ 2.4X16	132311016	Titanium
$\Phi$ 2.4X18	132311018	Titanium
$\Phi$ 2.4X20	132311020	Titanium
$\Phi$ 2.4X22	132311022	Titanium
$\Phi$ 2.4X24	132311024	Titanium
$\Phi$ 2.4X26	132311026	Titanium
$\Phi$ 2.4X28	132311028	Titanium
$\Phi$ 2.4X30	132311030	Titanium

Small Locking Fragment Plating System SLP  
Locking Screw, self-tapping  $\Phi$ 2.4mm



Thread diameter	Depth	Spacing	Shank diameter	Head diameter
$\Phi$ 2.4	0.25	0.6	$\Phi$ 1.9	$\Phi$ 3.5
Head height	Head specifications(Unit:mm)			
2.3	/			

Specification	P.N	Material
$\Phi$ 2.4X8	132201008	Titanium
$\Phi$ 2.4X10	132201010	Titanium
$\Phi$ 2.4X11	132201011	Titanium
$\Phi$ 2.4X12	132201012	Titanium
$\Phi$ 2.4X13	132201013	Titanium
$\Phi$ 2.4X14	132201014	Titanium
$\Phi$ 2.4X16	132201016	Titanium
$\Phi$ 2.4X18	132201018	Titanium
$\Phi$ 2.4X20	132201020	Titanium
$\Phi$ 2.4X22	132201022	Titanium
$\Phi$ 2.4X24	132201024	Titanium
$\Phi$ 2.4X26	132201026	Titanium
$\Phi$ 2.4X28	132201028	Titanium
$\Phi$ 2.4X30	132201030	Titanium

**Screws**

Small Locking Fragment Plating System SLP  
Locking Screw, self-tapping  $\Phi 2.7\text{mm}$



Thread diameter	Depth	Spacing	Shank diameter	Head diameter
$\Phi 2.7$	0.3	0.6	$\Phi 2.1$	$\Phi 3.5$
Head height	Head specifications(Unit:mm)			
2.1	/			

Specification	P.N	Material
$\Phi 2.7 \times 8$	132202008	Titanium
$\Phi 2.7 \times 10$	132202010	Titanium
$\Phi 2.7 \times 12$	132202012	Titanium
$\Phi 2.7 \times 14$	132202014	Titanium
$\Phi 2.7 \times 16$	132202016	Titanium
$\Phi 2.7 \times 18$	132202018	Titanium
$\Phi 2.7 \times 20$	132202020	Titanium
$\Phi 2.7 \times 22$	132202022	Titanium
$\Phi 2.7 \times 24$	132202024	Titanium
$\Phi 2.7 \times 26$	132202026	Titanium
$\Phi 2.7 \times 28$	132202028	Titanium
$\Phi 2.7 \times 30$	132202030	Titanium
$\Phi 2.7 \times 35$	132202035	Titanium
$\Phi 2.7 \times 40$	132202040	Titanium
$\Phi 2.7 \times 45$	132202045	Titanium
$\Phi 2.7 \times 50$	132202050	Titanium
$\Phi 2.7 \times 55$	132202055	Titanium
$\Phi 2.7 \times 60$	132202060	Titanium

Small Locking Fragment Plating System SLP  
Locking Screw, self-tapping  $\Phi 3.5\text{mm}$



Thread diameter	Depth	Spacing	Shank diameter	Head diameter
$\Phi 3.5$	/	/	$\Phi 2.9$	$\Phi 4.9$
Head height	Head specifications(Unit:mm)			
2.6	T2.5			

Specification	P.N	Material
$\Phi 3.5 \times 10$	132214010	Titanium
$\Phi 3.5 \times 12$	132214012	Titanium
$\Phi 3.5 \times 14$	132214014	Titanium
$\Phi 3.5 \times 16$	132214016	Titanium
$\Phi 3.5 \times 18$	132214018	Titanium
$\Phi 3.5 \times 20$	132214020	Titanium
$\Phi 3.5 \times 22$	132214022	Titanium
$\Phi 3.5 \times 24$	132214024	Titanium
$\Phi 3.5 \times 26$	132214026	Titanium
$\Phi 3.5 \times 28$	132214028	Titanium
$\Phi 3.5 \times 30$	132214030	Titanium
$\Phi 3.5 \times 32$	132214032	Titanium
$\Phi 3.5 \times 34$	132214034	Titanium
$\Phi 3.5 \times 35$	132214035	Titanium
$\Phi 3.5 \times 36$	132214036	Titanium
$\Phi 3.5 \times 38$	132214038	Titanium
$\Phi 3.5 \times 40$	132214040	Titanium
$\Phi 3.5 \times 42$	132214042	Titanium
$\Phi 3.5 \times 44$	132214044	Titanium
$\Phi 3.5 \times 45$	132214045	Titanium
$\Phi 3.5 \times 46$	132214046	Titanium
$\Phi 3.5 \times 48$	132214048	Titanium
$\Phi 3.5 \times 50$	132214050	Titanium
$\Phi 3.5 \times 55$	132214055	Titanium
$\Phi 3.5 \times 60$	132214060	Titanium
$\Phi 3.5 \times 65$	132214065	Titanium
$\Phi 3.5 \times 70$	132214070	Titanium
$\Phi 3.5 \times 75$	132214075	Titanium
$\Phi 3.5 \times 80$	132214080	Titanium
$\Phi 3.5 \times 85$	132214085	Titanium
$\Phi 3.5 \times 90$	132214090	Titanium

Small Locking Fragment Plating System SLP  
Locking Spacer



Specification	P.N	Material
$\Phi 3.5$	132211002	Titanium

**Screws**

Large Locking Fragment Plating System LLP  
Locking Screw, self-tapping  $\Phi 5.0\text{mm}$



Thread diameter	Depth	Spacing	Shank diameter	Head diameter
$\Phi 5$	/	/	$\Phi 4.4$	$\Phi 6.6$

Head height	Head specifications(Unit:mm)
4	T25

Specification	P.N	Material
$\Phi 5.0 \times 14$	133202014	Titanium
$\Phi 5.0 \times 16$	133202016	Titanium
$\Phi 5.0 \times 18$	133202018	Titanium
$\Phi 5.0 \times 20$	133202020	Titanium
$\Phi 5.0 \times 22$	133202022	Titanium
$\Phi 5.0 \times 24$	133202024	Titanium
$\Phi 5.0 \times 26$	133202026	Titanium
$\Phi 5.0 \times 28$	133202028	Titanium
$\Phi 5.0 \times 30$	133202030	Titanium
$\Phi 5.0 \times 32$	133202032	Titanium
$\Phi 5.0 \times 34$	133202034	Titanium
$\Phi 5.0 \times 36$	133202036	Titanium
$\Phi 5.0 \times 38$	133202038	Titanium
$\Phi 5.0 \times 40$	133202040	Titanium
$\Phi 5.0 \times 42$	133202042	Titanium
$\Phi 5.0 \times 44$	133202044	Titanium
$\Phi 5.0 \times 45$	133202045	Titanium
$\Phi 5.0 \times 46$	133202046	Titanium
$\Phi 5.0 \times 48$	133202048	Titanium
$\Phi 5.0 \times 50$	133202050	Titanium
$\Phi 5.0 \times 55$	133202055	Titanium
$\Phi 5.0 \times 60$	133202060	Titanium
$\Phi 5.0 \times 65$	133202065	Titanium
$\Phi 5.0 \times 70$	133202070	Titanium
$\Phi 5.0 \times 75$	133202075	Titanium
$\Phi 5.0 \times 80$	133202080	Titanium
$\Phi 5.0 \times 85$	133202085	Titanium
$\Phi 5.0 \times 90$	133202090	Titanium
$\Phi 5.0 \times 95$	133202095	Titanium
$\Phi 5.0 \times 100$	133202100	Titanium

Large Locking Fragment Plating System LLP  
Spacer



Specification	P.N	Material
$\Phi 5.0$	133219002	Titanium

Large Locking Fragment Plating System LLP  
Periporsthetic Screw  $\Phi 5.0\text{mm}$



Thread diameter	Depth	Spacing	Shank diameter
$\Phi 5.0$	0.3	1	$\Phi 4.4$

Head diameter	Head height	Head specifications(Unit:mm)
$\Phi 6.6$	3.5	T25

Specification	P.N	Material
$\Phi 5.0 \times 14$	133203214	Titanium
$\Phi 5.0 \times 18$	133203218	Titanium

**Screws**

Large Locking Fragment Plating System LLP  
Locking Screw , self-drilling  $\Phi 5.0$ mm



Thread diameter	Depth	Spacing	Shank diameter	Head diameter
$\Phi 5.0$	0.3	1	$\Phi 4.4$	$\Phi 6.6$

Head height	Head specifications(Unit:mm)
3.5	T25

Specification	P.N	Material
$\Phi 5.0 \times 18$	133203018	Titanium
$\Phi 5.0 \times 20$	133203020	Titanium
$\Phi 5.0 \times 22$	133203022	Titanium
$\Phi 5.0 \times 24$	133203024	Titanium
$\Phi 5.0 \times 26$	133203026	Titanium
$\Phi 5.0 \times 28$	133203028	Titanium
$\Phi 5.0 \times 30$	133203030	Titanium
$\Phi 5.0 \times 32$	133203032	Titanium
$\Phi 5.0 \times 34$	133203034	Titanium
$\Phi 5.0 \times 36$	133203036	Titanium
$\Phi 5.0 \times 38$	133203038	Titanium
$\Phi 5.0 \times 40$	133203040	Titanium
$\Phi 5.0 \times 42$	133203042	Titanium
$\Phi 5.0 \times 44$	133203044	Titanium
$\Phi 5.0 \times 45$	133203045	Titanium
$\Phi 5.0 \times 46$	133203046	Titanium
$\Phi 5.0 \times 48$	133203048	Titanium
$\Phi 5.0 \times 50$	133203050	Titanium
$\Phi 5.0 \times 55$	133203055	Titanium
$\Phi 5.0 \times 60$	133203060	Titanium
$\Phi 5.0 \times 65$	133203065	Titanium
$\Phi 5.0 \times 70$	133203070	Titanium
$\Phi 5.0 \times 75$	133203075	Titanium
$\Phi 5.0 \times 80$	133203080	Titanium
$\Phi 5.0 \times 85$	133203085	Titanium
$\Phi 5.0 \times 90$	133203090	Titanium
$\Phi 5.0 \times 95$	133203095	Titanium
$\Phi 5.0 \times 100$	133203100	Titanium

Cannulated Screw

Cannulated Screw System NUS  
Cannulated Screw  $\Phi 3.0\text{mm}$



Thread diameter    Shank diameter    Head diameter  
 $\Phi 3.0$                      $\Phi 2.0$                      $\Phi 4$

Specification	P.N	Material
$\Phi 3.0 \times 10$	134631010	Titanium
$\Phi 3.0 \times 11$	134631011	Titanium
$\Phi 3.0 \times 12$	134631012	Titanium
$\Phi 3.0 \times 13$	134631013	Titanium
$\Phi 3.0 \times 14$	134631014	Titanium
$\Phi 3.0 \times 15$	134631015	Titanium
$\Phi 3.0 \times 16$	134631016	Titanium
$\Phi 3.0 \times 17$	134631017	Titanium
$\Phi 3.0 \times 18$	134631018	Titanium
$\Phi 3.0 \times 19$	134631019	Titanium
$\Phi 3.0 \times 20$	134631020	Titanium
$\Phi 3.0 \times 21$	134631021	Titanium
$\Phi 3.0 \times 22$	134631022	Titanium
$\Phi 3.0 \times 23$	134631023	Titanium
$\Phi 3.0 \times 24$	134631024	Titanium
$\Phi 3.0 \times 25$	134631025	Titanium
$\Phi 3.0 \times 26$	134631026	Titanium
$\Phi 3.0 \times 27$	134631027	Titanium
$\Phi 3.0 \times 28$	134631028	Titanium
$\Phi 3.0 \times 29$	134631029	Titanium
$\Phi 3.0 \times 30$	134631030	Titanium
$\Phi 3.0 \times 32$	134631032	Titanium
$\Phi 3.0 \times 34$	134631034	Titanium
$\Phi 3.0 \times 36$	134631036	Titanium
$\Phi 3.0 \times 38$	134631038	Titanium
$\Phi 3.0 \times 40$	134631040	Titanium

Cannulated Screw System NUS  
Cannulated Screw  $\Phi 4.5\text{mm}$ , self-drilling



Thread diameter    Shank diameter    Head diameter  
 $\Phi 4.5$                      $\Phi 2.7$                      $\Phi 6.5$

Specification	P.N	Length(mm)	Material
$\Phi 4.5 \times 20$	134211020	7	Titanium
$\Phi 4.5 \times 22$	134211022	7	Titanium
$\Phi 4.5 \times 24$	134211024	8	Titanium
$\Phi 4.5 \times 26$	134211026	9	Titanium
$\Phi 4.5 \times 28$	134211028	9	Titanium
$\Phi 4.5 \times 30$	134211030	10	Titanium
$\Phi 4.5 \times 32$	134211032	11	Titanium
$\Phi 4.5 \times 34$	134211034	11	Titanium
$\Phi 4.5 \times 36$	134211036	12	Titanium
$\Phi 4.5 \times 38$	134211038	13	Titanium
$\Phi 4.5 \times 40$	134211040	13	Titanium
$\Phi 4.5 \times 42$	134211042	14	Titanium
$\Phi 4.5 \times 44$	134211044	15	Titanium
$\Phi 4.5 \times 46$	134211046	15	Titanium
$\Phi 4.5 \times 48$	134211048	16	Titanium
$\Phi 4.5 \times 50$	134211050	17	Titanium
$\Phi 4.5 \times 52$	134211052	17	Titanium
$\Phi 4.5 \times 54$	134211054	18	Titanium
$\Phi 4.5 \times 56$	134211056	19	Titanium
$\Phi 4.5 \times 60$	134211060	20	Titanium
$\Phi 4.5 \times 64$	134211064	21	Titanium
$\Phi 4.5 \times 68$	134211068	23	Titanium
$\Phi 4.5 \times 72$	134211072	24	Titanium

## Cannulated Screw

Cannulated Screw System NUS  
Cannulated Screw  $\Phi$ 6.5mm, self-drilling, thread length 16mm



Thread diameter    Shank diameter    Head diameter  
 $\Phi$  6.5                      4.2                       $\Phi$  8

Specification	P.N	Material
$\Phi$ 6.5×40	134311040	Titanium
$\Phi$ 6.5×45	134311045	Titanium
$\Phi$ 6.5×50	134311050	Titanium
$\Phi$ 6.5×55	134311055	Titanium
$\Phi$ 6.5×60	134311060	Titanium
$\Phi$ 6.5×65	134311065	Titanium
$\Phi$ 6.5×70	134311070	Titanium
$\Phi$ 6.5×75	134311075	Titanium
$\Phi$ 6.5×80	134311080	Titanium
$\Phi$ 6.5×85	134311085	Titanium
$\Phi$ 6.5×90	134311090	Titanium
$\Phi$ 6.5×95	134311095	Titanium
$\Phi$ 6.5×100	134311100	Titanium
$\Phi$ 6.5×105	134311105	Titanium
$\Phi$ 6.5×110	134311110	Titanium
$\Phi$ 6.5×115	134311115	Titanium
$\Phi$ 6.5×120	134311120	Titanium
$\Phi$ 6.5×125	134311125	Titanium
$\Phi$ 6.5×130	134311130	Titanium

Cannulated Screw System NUS  
Cannulated Screw  $\Phi$ 6.5mm, self-drilling, thread length 32mm



Thread diameter    Shank diameter    Head diameter  
 $\Phi$  6.5                       $\Phi$  4.2                       $\Phi$  8

Specification	P.N	Material
6.5X40	134312040	Titanium
$\Phi$ 6.5X45	134312045	Titanium
$\Phi$ 6.5X50	134312050	Titanium
$\Phi$ 6.5X55	134312055	Titanium
$\Phi$ 6.5X60	134312060	Titanium
$\Phi$ 6.5X65	134312065	Titanium
$\Phi$ 6.5X70	134312070	Titanium
$\Phi$ 6.5X75	134312075	Titanium
$\Phi$ 6.5X80	134312080	Titanium
$\Phi$ 6.5X85	134312085	Titanium
$\Phi$ 6.5X90	134312090	Titanium
$\Phi$ 6.5X95	134312095	Titanium
$\Phi$ 6.5X100	134312100	Titanium
$\Phi$ 6.5X105	134312105	Titanium
$\Phi$ 6.5X110	134312110	Titanium
$\Phi$ 6.5X115	134312115	Titanium
$\Phi$ 6.5X120	134312120	Titanium
$\Phi$ 6.5X125	134312125	Titanium
$\Phi$ 6.5X130	134312130	Titanium

## Cannulated Screw

Cannulated Screw System NUS  
Cannulated Screw  $\Phi$ 7.3mm, self-drilling,  
thread length 16mm



Thread diameter    Shank diameter    Head diameter  
 $\Phi$ 7.3                       $\Phi$ 4.5                       $\Phi$ 8

Specification	P.N	Material
$\Phi$ 7.3X40	134411040	Titanium
$\Phi$ 7.3X45	134411045	Titanium
$\Phi$ 7.3X50	134411050	Titanium
$\Phi$ 7.3X55	134411055	Titanium
$\Phi$ 7.3X60	134411060	Titanium
$\Phi$ 7.3X65	134411065	Titanium
$\Phi$ 7.3X70	134411070	Titanium
$\Phi$ 7.3X75	134411075	Titanium
$\Phi$ 7.3X80	134411080	Titanium
$\Phi$ 7.3X85	134411085	Titanium
$\Phi$ 7.3X90	134411090	Titanium
$\Phi$ 7.3X95	134411095	Titanium
$\Phi$ 7.3X100	134411100	Titanium
$\Phi$ 7.3X105	134411105	Titanium
$\Phi$ 7.3X110	134411110	Titanium
$\Phi$ 7.3X115	134411115	Titanium
$\Phi$ 7.3X120	134411120	Titanium
$\Phi$ 7.3X125	134411125	Titanium
$\Phi$ 7.3X130	134411130	Titanium
$\Phi$ 7.3X140	134411140	Titanium

Cannulated Screw System NUS  
Cannulated Screw  $\Phi$ 7.3mm, self-drilling,  
thread length 32mm



Thread diameter    Shank diameter    Head diameter  
 $\Phi$ 7.3                       $\Phi$ 4.5                       $\Phi$ 8

Specification	P.N	Material
$\Phi$ 7.3X40	134412040	Titanium
$\Phi$ 7.3X45	134412045	Titanium
$\Phi$ 7.3X50	134412050	Titanium
$\Phi$ 7.3X55	134412055	Titanium
$\Phi$ 7.3X60	134412060	Titanium
$\Phi$ 7.3X65	134412065	Titanium
$\Phi$ 7.3X70	134412070	Titanium
$\Phi$ 7.3X75	134412075	Titanium
$\Phi$ 7.3X80	134412080	Titanium
$\Phi$ 7.3X85	134412085	Titanium
$\Phi$ 7.3X90	134412090	Titanium
$\Phi$ 7.3X95	134412095	Titanium
$\Phi$ 7.3X100	134412100	Titanium
$\Phi$ 7.3X105	134412105	Titanium
$\Phi$ 7.3X110	134412110	Titanium
$\Phi$ 7.3X115	134412115	Titanium
$\Phi$ 7.3X120	134412120	Titanium
$\Phi$ 7.3X125	134412125	Titanium
$\Phi$ 7.3X130	134412130	Titanium
$\Phi$ 7.3X140	134412140	Titanium



Cannulated Screw

Cannulated Screw System NUS  
Washer



Specification	P.N	Material
Φ3.0	134630000	Titanium

Cannulated Screw System NUS  
Washer



Specification	P.N	Material
Φ6.5/7.3	134411000	Titanium
Φ4.5	134211000	Titanium

Headless Compression Cannulated Screw

Headless Compression Screw  $\Phi$ 2.5mm



Specification	P.N	Material
$\Phi$ 2.5×8	134713008	Titanium
$\Phi$ 2.5×9	134713009	Titanium
$\Phi$ 2.5×10	134713010	Titanium
$\Phi$ 2.5×11	134713011	Titanium
$\Phi$ 2.5×12	134713012	Titanium
$\Phi$ 2.5×13	134713013	Titanium
$\Phi$ 2.5×14	134713014	Titanium
$\Phi$ 2.5×16	134713016	Titanium
$\Phi$ 2.5×18	134713018	Titanium
$\Phi$ 2.5×20	134713020	Titanium
$\Phi$ 2.5×22	134713022	Titanium
$\Phi$ 2.5×24	134713024	Titanium
$\Phi$ 2.5×26	134713026	Titanium
$\Phi$ 2.5×28	134713028	Titanium
$\Phi$ 2.5×30	134713030	Titanium

Headless Compression Screw  $\Phi$ 3.0mm



Specification	P.N	Material
$\Phi$ 3. 0×10	134623010	Titanium
$\Phi$ 3. 0×11	134713011	Titanium
$\Phi$ 3. 0×12	134713012	Titanium
$\Phi$ 3. 0×13	134713013	Titanium
$\Phi$ 3. 0×14	134713014	Titanium
$\Phi$ 3. 0×16	134713016	Titanium
$\Phi$ 3. 0×18	134713018	Titanium
$\Phi$ 3. 0×20	134713020	Titanium
$\Phi$ 3. 0×22	134713022	Titanium
$\Phi$ 3. 0×24	134713024	Titanium
$\Phi$ 3. 0×26	134713026	Titanium
$\Phi$ 3. 0×28	134713028	Titanium
$\Phi$ 3. 0×30	134713030	Titanium

Headless Compression Screw  $\Phi$ 3.5mm



Specification	P.N	Material
$\Phi$ 3.5×16	134823016	Titanium
$\Phi$ 3.5×18	134823018	Titanium
$\Phi$ 3.5×20	134823020	Titanium
$\Phi$ 3.5×22	134823022	Titanium
$\Phi$ 3.5×24	134823024	Titanium
$\Phi$ 3.5×26	134823026	Titanium
$\Phi$ 3.5×28	134823028	Titanium
$\Phi$ 3.5×30	134823030	Titanium

Headless Compression Cannulated Screw

Headless Compression Screw  $\Phi$ 4.0mm



Specification	P.N	Material
$\Phi$ 4. 0 $\times$ 16	134923016	Titanium
$\Phi$ 4. 0 $\times$ 18	134923018	Titanium
$\Phi$ 4. 0 $\times$ 20	134923020	Titanium
$\Phi$ 4. 0 $\times$ 22	134923022	Titanium
$\Phi$ 4. 0 $\times$ 24	134923024	Titanium
$\Phi$ 4. 0 $\times$ 26	134923026	Titanium
$\Phi$ 4. 0 $\times$ 28	134923028	Titanium
$\Phi$ 4. 0 $\times$ 30	134923030	Titanium
$\Phi$ 4. 0 $\times$ 32	134923032	Titanium
$\Phi$ 4. 0 $\times$ 34	134923034	Titanium

Headless Compression Screw  $\Phi$ 4.5mm



Specification	P.N	Material
$\Phi$ 4.5 $\times$ 20	134223020	Titanium
$\Phi$ 4.5 $\times$ 22	134223022	Titanium
$\Phi$ 4.5 $\times$ 24	134223024	Titanium
$\Phi$ 4.5 $\times$ 26	134223026	Titanium
$\Phi$ 4.5 $\times$ 28	134223028	Titanium
$\Phi$ 4.5 $\times$ 30	134223030	Titanium
$\Phi$ 4.5 $\times$ 35	134223035	Titanium
$\Phi$ 4.5 $\times$ 40	134223040	Titanium
$\Phi$ 4.5 $\times$ 45	134223045	Titanium
$\Phi$ 4.5 $\times$ 50	134223050	Titanium

Headless Compression Screw  $\Phi$ 5.0mm



Specification	P.N	Material
$\Phi$ 5. 0 $\times$ 25	134023025	Titanium
$\Phi$ 5. 0 $\times$ 30	134023030	Titanium
$\Phi$ 5. 0 $\times$ 35	134023035	Titanium
$\Phi$ 5. 0 $\times$ 40	134023040	Titanium
$\Phi$ 5. 0 $\times$ 45	134023045	Titanium
$\Phi$ 5. 0 $\times$ 50	134023050	Titanium
$\Phi$ 5. 0 $\times$ 55	134023055	Titanium
$\Phi$ 5. 0 $\times$ 60	134023060	Titanium

Headless Compression Screw  $\Phi$ 6.5mm



Specification	P.N	Material
$\Phi$ 6.5 $\times$ 40	134323340	Titanium
$\Phi$ 6.5 $\times$ 45	134323345	Titanium
$\Phi$ 6.5 $\times$ 50	134323350	Titanium
$\Phi$ 6.5 $\times$ 55	134323355	Titanium
$\Phi$ 6.5 $\times$ 60	134323360	Titanium
$\Phi$ 6.5 $\times$ 65	134323365	Titanium
$\Phi$ 6.5 $\times$ 70	134323370	Titanium
$\Phi$ 6.5 $\times$ 75	134323375	Titanium
$\Phi$ 6.5 $\times$ 80	134323380	Titanium
$\Phi$ 6.5 $\times$ 85	134323385	Titanium
$\Phi$ 6.5 $\times$ 90	134323390	Titanium
$\Phi$ 6.5 $\times$ 95	134323395	Titanium
$\Phi$ 6.5 $\times$ 100	134323400	Titanium
$\Phi$ 6.5 $\times$ 105	134323405	Titanium
$\Phi$ 6.5 $\times$ 110	134323410	Titanium
$\Phi$ 6.5 $\times$ 115	134323415	Titanium
$\Phi$ 6.5 $\times$ 120	134323420	Titanium

## Headless Compression Cannulated Screw

### Headless Cannulated Screw $\Phi$ 2.5mm



Specification	P.N	Material
$\Phi$ 2.5 $\times$ 8	134713108	Titanium
$\Phi$ 2.5 $\times$ 9	134713109	Titanium
$\Phi$ 2.5 $\times$ 10	134713110	Titanium
$\Phi$ 2.5 $\times$ 11	134713111	Titanium
$\Phi$ 2.5 $\times$ 12	134713112	Titanium
$\Phi$ 2.5 $\times$ 13	134713113	Titanium
$\Phi$ 2.5 $\times$ 14	134713114	Titanium
$\Phi$ 2.5 $\times$ 16	134713116	Titanium
$\Phi$ 2.5 $\times$ 18	134713118	Titanium
$\Phi$ 2.5 $\times$ 20	134713120	Titanium
$\Phi$ 2.5 $\times$ 22	134713122	Titanium
$\Phi$ 2.5 $\times$ 24	134713124	Titanium
$\Phi$ 2.5 $\times$ 26	134713126	Titanium
$\Phi$ 2.5 $\times$ 28	134713128	Titanium
$\Phi$ 2.5 $\times$ 30	134713130	Titanium

### Headless Cannulated Screw $\Phi$ 3.0mm



Specification	P.N	Material
$\Phi$ 3.0 $\times$ 10	134623110	Titanium
$\Phi$ 3.0 $\times$ 11	134623111	Titanium
$\Phi$ 3.0 $\times$ 12	134623112	Titanium
$\Phi$ 3.0 $\times$ 13	134623113	Titanium
$\Phi$ 3.0 $\times$ 14	134623114	Titanium
$\Phi$ 3.0 $\times$ 16	134623116	Titanium
$\Phi$ 3.0 $\times$ 18	134623118	Titanium
$\Phi$ 3.0 $\times$ 20	134623120	Titanium
$\Phi$ 3.0 $\times$ 22	134623122	Titanium
$\Phi$ 3.0 $\times$ 24	134623124	Titanium
$\Phi$ 3.0 $\times$ 26	134623126	Titanium
$\Phi$ 3.0 $\times$ 28	134623128	Titanium
$\Phi$ 3.0 $\times$ 30	134623130	Titanium

### Headless Cannulated Screw $\Phi$ 3.5mm



Specification	P.N	Material
$\Phi$ 3.5 $\times$ 16	134823116	Titanium
$\Phi$ 3.5 $\times$ 18	134823118	Titanium
$\Phi$ 3.5 $\times$ 20	134823120	Titanium
$\Phi$ 3.5 $\times$ 22	134823122	Titanium
$\Phi$ 3.5 $\times$ 24	134823124	Titanium
$\Phi$ 3.5 $\times$ 26	134823126	Titanium
$\Phi$ 3.5 $\times$ 28	134823128	Titanium
$\Phi$ 3.5 $\times$ 30	134823130	Titanium

## Headless Compression Cannulated Screw

### Headless Cannulated Screw $\Phi$ 4.0mm



Specification	P.N	Material
$\Phi$ 4. 0 $\times$ 16	134923116	Titanium
$\Phi$ 4. 0 $\times$ 18	134923118	Titanium
$\Phi$ 4. 0 $\times$ 20	134923120	Titanium
$\Phi$ 4. 0 $\times$ 22	134923122	Titanium
$\Phi$ 4. 0 $\times$ 24	134923124	Titanium
$\Phi$ 4. 0 $\times$ 26	134923126	Titanium
$\Phi$ 4. 0 $\times$ 28	134923128	Titanium
$\Phi$ 4. 0 $\times$ 30	134923130	Titanium
$\Phi$ 4. 0 $\times$ 32	134923132	Titanium
$\Phi$ 4. 0 $\times$ 34	134923134	Titanium

### Headless Cannulated Screw $\Phi$ 4.5mm



Specification	P.N	Material
$\Phi$ 4.5 $\times$ 20	134223120	Titanium
$\Phi$ 4.5 $\times$ 22	134223122	Titanium
$\Phi$ 4.5 $\times$ 24	134223124	Titanium
$\Phi$ 4.5 $\times$ 26	134223126	Titanium
$\Phi$ 4.5 $\times$ 28	134223128	Titanium
$\Phi$ 4.5 $\times$ 30	134223130	Titanium
$\Phi$ 4.5 $\times$ 35	134223135	Titanium
$\Phi$ 4.5 $\times$ 40	134223140	Titanium
$\Phi$ 4.5 $\times$ 45	134223145	Titanium
$\Phi$ 4.5 $\times$ 50	134223150	Titanium

### Headless Cannulated Screw $\Phi$ 5.0mm



Specification	P.N	Material
$\Phi$ 5.0 $\times$ 25	134023125	Titanium
$\Phi$ 5.0 $\times$ 30	134023130	Titanium
$\Phi$ 5.0 $\times$ 35	134023135	Titanium
$\Phi$ 5.0 $\times$ 40	134023140	Titanium
$\Phi$ 5.0 $\times$ 45	134023145	Titanium
$\Phi$ 5.0 $\times$ 50	134023150	Titanium
$\Phi$ 5.0 $\times$ 55	134023155	Titanium
$\Phi$ 5.0 $\times$ 60	134023160	Titanium

### Headless Cannulated Screw $\Phi$ 6.5mm



Specification	P.N	Material
$\Phi$ 6.5 $\times$ 40	134323540	Titanium
$\Phi$ 6.5 $\times$ 45	134323545	Titanium
$\Phi$ 6.5 $\times$ 50	134323550	Titanium
$\Phi$ 6.5 $\times$ 55	134323555	Titanium
$\Phi$ 6.5 $\times$ 60	134323560	Titanium
$\Phi$ 6.5 $\times$ 65	134323565	Titanium
$\Phi$ 6.5 $\times$ 70	134323570	Titanium
$\Phi$ 6.5 $\times$ 75	134323575	Titanium
$\Phi$ 6.5 $\times$ 80	134323580	Titanium
$\Phi$ 6.5 $\times$ 85	134323585	Titanium
$\Phi$ 6.5 $\times$ 90	134323590	Titanium
$\Phi$ 6.5 $\times$ 95	134323595	Titanium
$\Phi$ 6.5 $\times$ 100	134323600	Titanium
$\Phi$ 6.5 $\times$ 105	134323605	Titanium
$\Phi$ 6.5 $\times$ 110	134323610	Titanium
$\Phi$ 6.5 $\times$ 115	134323615	Titanium
$\Phi$ 6.5 $\times$ 120	134323620	Titanium

PFN Femoral Nails

Proximal Femoral Nail System PFN  
Nail(extended)



Specification	Direction	P.N	Material
Φ9X300	Left	135403530	Titanium
Φ9X320	Left	135403532	Titanium
Φ9X340	Left	135403534	Titanium
Φ9X360	Left	135403536	Titanium
Φ9X380	Left	135403538	Titanium
Φ9X400	Left	135403540	Titanium
Φ9X420	Left	135403542	Titanium
Φ10X300	Left	135403630	Titanium
Φ10X320	Left	135403632	Titanium
Φ10X340	Left	135403634	Titanium
Φ10X360	Left	135403636	Titanium
Φ10X380	Left	135403638	Titanium
Φ10X400	Left	135403640	Titanium
Φ10X420	Left	135403642	Titanium
Φ11X300	Left	135403730	Titanium
Φ11X320	Left	135403732	Titanium
Φ11X340	Left	135403734	Titanium
Φ11X360	Left	135403736	Titanium
Φ11X380	Left	135403738	Titanium
Φ11X400	Left	135403740	Titanium
Φ11X420	Left	135403742	Titanium
Φ9X300	Right	135404530	Titanium
Φ9X320	Right	135404532	Titanium
Φ9X340	Right	135404534	Titanium
Φ9X360	Right	135404536	Titanium
Φ9X380	Right	135404538	Titanium
Φ9X400	Right	135404540	Titanium
Φ9X420	Right	135404542	Titanium
Φ10X300	Right	135404630	Titanium
Φ10X320	Right	135404632	Titanium
Φ10X340	Right	135404634	Titanium
Φ10X360	Right	135404636	Titanium
Φ10X380	Right	135404638	Titanium
Φ10X400	Right	135404640	Titanium
Φ10X420	Right	135404642	Titanium
Φ11X300	Right	135404730	Titanium
Φ11X320	Right	135404732	Titanium
Φ11X340	Right	135404734	Titanium
Φ11X360	Right	135404736	Titanium
Φ11X380	Right	135404738	Titanium
Φ11X400	Right	135404740	Titanium
Φ11X420	Right	135404742	Titanium

Proximal Femoral Nail System PFN  
Nail(standard)



Specification	P.N	Material
Φ9X170	135406517	Titanium
Φ9X200	135406520	Titanium
Φ9X240	135406524	Titanium
Φ10X170	135406617	Titanium
Φ10X200	135406620	Titanium
Φ10X240	135406624	Titanium
Φ11X170	135406717	Titanium
Φ11X200	135406720	Titanium
Φ11X240	135406724	Titanium
Φ12×170	135406817	Titanium
Φ12×200	135406820	Titanium
Φ12×240	135406824	Titanium
Φ13×170	135406917	Titanium
Φ13×200	135406920	Titanium
Φ13×240	135406924	Titanium

PFN Femoral Nails

Proximal Femoral Nail System PFN  
Locking screw



Specification	P.N	Material
Φ4.9X20	135400020	Titanium
Φ4.9X24	135400024	Titanium
Φ4.9X28	135400028	Titanium
Φ4.9X30	135400030	Titanium
Φ4.9X32	135400032	Titanium
Φ4.9X34	135400034	Titanium
Φ4.9X36	135400036	Titanium
Φ4.9X38	135400038	Titanium
Φ4.9X40	135400040	Titanium
Φ4.9X42	135400042	Titanium
Φ4.9X44	135400044	Titanium
Φ4.9X46	135400046	Titanium
Φ4.9X48	135400048	Titanium
Φ4.9X50	135400050	Titanium
Φ4.9X52	135400052	Titanium
Φ4.9X56	135400056	Titanium
Φ4.9X60	135400060	Titanium
Φ4.9X64	135400064	Titanium
Φ4.9X68	135400068	Titanium
Φ4.9X70	135400070	Titanium
Φ4.9X72	135400072	Titanium
Φ4.9X76	135400076	Titanium
Φ4.9X80	135400080	Titanium

Proximal Femoral Nail System PFN  
Lag screw



Specification	P.N	Material
Φ10.4X70	135400270	Titanium
Φ10.4X75	135400275	Titanium
Φ10.4X80	135400280	Titanium
Φ10.4X85	135400285	Titanium
Φ10.4X90	135400290	Titanium
Φ10.4X95	135400295	Titanium
Φ10.4X100	135400200	Titanium
Φ10.4X105	135400205	Titanium
Φ10.4X110	135400210	Titanium
Φ10.4X115	135400215	Titanium
Φ10.4X120	135400220	Titanium

Proximal Femoral Nail System PFN  
Helical blade



Specification	P.N	Material
Φ10.4X75	135400375	Titanium
Φ10.4X80	135400380	Titanium
Φ10.4X85	135400385	Titanium
Φ10.4X90	135400390	Titanium
Φ10.4X95	135400395	Titanium
Φ10.4X100	135400300	Titanium
Φ10.4X105	135400305	Titanium
Φ10.4X110	135400310	Titanium
Φ10.4X115	135400315	Titanium
Φ10.4X120	135400320	Titanium

PFN Femoral Nails

Proximal Femoral Nail System PFN  
End cap



Specification	P.N	Diameter	Length	Material
5	135400101	Φ13.7	23.5	Titanium
10	135400102	Φ16.5	31	Titanium
15	135400103	Φ16.5	36	Titanium

Proximal Femoral Nail System PFN  
End cap II



Specification	P.N	Diameter	Length	Material
5	135400104	Φ16.5	41	Titanium
10	135400105	Φ16.5	46	Titanium
15	135400106	Φ16.5	51	Titanium



EFN Femoral Nails

Proximal Femoral Nail System EFN  
Nail(Cannulated)



Specification	Direction	P.N	Material
Φ9X300	Left	135503530	Titanium
Φ9X320	Left	135503532	Titanium
Φ9X340	Left	135503534	Titanium
Φ9X360	Left	135503536	Titanium
Φ9X380	Left	135503538	Titanium
Φ9X400	Left	135503540	Titanium
Φ9X420	Left	135503542	Titanium
Φ9X440	Left	135503544	Titanium
Φ9X460	Left	135503546	Titanium
Φ10X300	Left	135503630	Titanium
Φ10X320	Left	135503632	Titanium
Φ10X340	Left	135503634	Titanium
Φ10X360	Left	135503636	Titanium
Φ10X380	Left	135503638	Titanium
Φ10X400	Left	135503640	Titanium
Φ10X420	Left	135503642	Titanium
Φ10X440	Left	135503644	Titanium
Φ10X460	Left	135503646	Titanium
Φ11X300	Left	135503730	Titanium
Φ11X320	Left	135503732	Titanium
Φ11X340	Left	135503734	Titanium
Φ11X360	Left	135503736	Titanium
Φ11X380	Left	135503738	Titanium
Φ11X400	Left	135503740	Titanium
Φ11X420	Left	135503742	Titanium
Φ11X440	Left	135503744	Titanium
Φ11X460	Left	135503746	Titanium
Φ12×300	Left	135503830	Titanium
Φ12×320	Left	135503832	Titanium
Φ12×340	Left	135503834	Titanium
Φ12×360	Left	135503836	Titanium
Φ12×380	Left	135503838	Titanium
Φ12×400	Left	135503840	Titanium
Φ12×420	Left	135503842	Titanium
Φ12×440	Left	135503844	Titanium
Φ12×460	Left	135503846	Titanium
Φ9X300	Right	135504530	Titanium
Φ9X320	Right	135504532	Titanium
Φ9X340	Right	135504534	Titanium
Φ9X360	Right	135504536	Titanium
Φ9X380	Right	135504538	Titanium
Φ9X400	Right	135504540	Titanium
Φ9X420	Right	135504542	Titanium
Φ9X440	Right	135504544	Titanium
Φ9X460	Right	135504546	Titanium
Φ10X300	Right	135504630	Titanium
Φ10X320	Right	135504632	Titanium
Φ10X340	Right	135504634	Titanium
Φ10X360	Right	135504636	Titanium
Φ10X380	Right	135504638	Titanium
Φ10X400	Right	135504640	Titanium
Φ10X420	Right	135504642	Titanium
Φ10X440	Right	135504644	Titanium
Φ10X460	Right	135504646	Titanium
Φ11X300	Right	135504730	Titanium
Φ11X320	Right	135504732	Titanium
Φ11X340	Right	135504734	Titanium
Φ11X360	Right	135504736	Titanium
Φ11X380	Right	135504738	Titanium
Φ11X400	Right	135504740	Titanium
Φ11X420	Right	135504742	Titanium
Φ11X440	Right	135504744	Titanium
Φ11X460	Right	135504746	Titanium
Φ12×300	Right	135504830	Titanium
Φ12×320	Right	135504832	Titanium
Φ12×340	Right	135504834	Titanium
Φ12×360	Right	135504836	Titanium
Φ12×380	Right	135504838	Titanium
Φ12×400	Right	135504840	Titanium
Φ12×420	Right	135504842	Titanium
Φ12×440	Right	135504844	Titanium
Φ12×460	Right	135504846	Titanium

EFN Femoral Nails

Proximal Femoral Nail System EFN  
End cap



Specification	P.N	Material
5	135500101	Titanium
5	135500102	Titanium
10	135500103	Titanium
15	135500104	Titanium
20	135500105	Titanium
25	135500106	Titanium

Proximal Femoral Nail System EFN  
Lag Screw



Specification	P.N	Material
Φ7X60	135500260	Titanium
Φ7X65	135500265	Titanium
Φ7X70	135500270	Titanium
Φ7X75	135500275	Titanium
Φ7X80	135500280	Titanium
Φ7X85	135500285	Titanium
Φ7X90	135500290	Titanium
Φ7X95	135500295	Titanium
Φ7X100	135500200	Titanium
Φ7X105	135500205	Titanium
Φ7X110	135500210	Titanium
Φ7X115	135500215	Titanium
Φ7X120	135500220	Titanium
Φ7X125	135500225	Titanium
Φ7X130	135500230	Titanium
Φ7X135	135500235	Titanium
Φ7X140	135500240	Titanium
Φ7X145	135500245	Titanium
Φ7X150	135500250	Titanium

TN Tibial Nails

Tibia Nail System TN  
Tibia Nail



Specification	P.N	Material
Φ 8X250	135705425	Titanium
Φ 8X265	135705426	Titanium
Φ 8X280	135705428	Titanium
Φ 8X295	135705429	Titanium
Φ 8X310	135705431	Titanium
Φ 8X325	135705432	Titanium
Φ 8X340	135705434	Titanium
Φ 8X355	135705435	Titanium
Φ 8X375	135705437	Titanium
Φ 8X395	135705439	Titanium
Φ 8X415	135705441	Titanium
Φ 9X250	135705525	Titanium
Φ 9X265	135705526	Titanium
Φ 9X280	135705528	Titanium
Φ 9X295	135705529	Titanium
Φ 9X310	135705531	Titanium
Φ 9X325	135705532	Titanium
Φ 9X340	135705534	Titanium
Φ 9X355	135705535	Titanium
Φ 9X375	135705537	Titanium
Φ 9X395	135705539	Titanium
Φ 9X415	135705541	Titanium
Φ 10X250	135705625	Titanium
Φ 10X265	135705626	Titanium
Φ 10X280	135705628	Titanium
Φ 10X295	135705629	Titanium
Φ 10X310	135705631	Titanium
Φ 10X325	135705632	Titanium
Φ 10X340	135705634	Titanium
Φ 10X355	135705635	Titanium
Φ 10X375	135705637	Titanium
Φ 10X395	135705639	Titanium
Φ 10X415	135705641	Titanium

Tibia Nail System ETN  
End Cap I



Specification	P.N	Material
15	135700115	Titanium
20	135700120	Titanium
25	135700125	Titanium
30	135700130	Titanium

## TN Tibial Nails

### Tibia Nail System TN Locking Screw



Specification	P.N	Material
Φ 3.9X26	135700026	Titanium
Φ 3.9X28	135700028	Titanium
Φ 3.9X30	135700030	Titanium
Φ 3.9X32	135700032	Titanium
Φ 3.9X34	135700034	Titanium
Φ 3.9X36	135700036	Titanium
Φ 3.9X38	135700038	Titanium
Φ 3.9X40	135700040	Titanium
Φ 3.9X42	135700042	Titanium
Φ 3.9X44	135700044	Titanium
Φ 3.9X46	135700046	Titanium
Φ 3.9X48	135700048	Titanium
Φ 3.9X50	135700050	Titanium
Φ 3.9X52	135700052	Titanium
Φ 3.9X54	135700054	Titanium
Φ 3.9X56	135700056	Titanium
Φ 3.9X58	135700058	Titanium
Φ 3.9X60	135700060	Titanium
Φ 3.9X64	135700064	Titanium
Φ 3.9X68	135700068	Titanium
Φ 3.9X72	135700072	Titanium
Φ 3.9X76	135700076	Titanium
Φ 3.9X80	135700080	Titanium

## TN Tibial Nails

Tibia Nail System ETN  
Tibia Nail(Cannulated)



Specification	P.N	Material
Φ 8×255	135716425	Titanium
Φ 8×270	135716427	Titanium
Φ 8×285	135716428	Titanium
Φ 8×300	135716430	Titanium
Φ 8×315	135716431	Titanium
Φ 8×330	135716433	Titanium
Φ 8×345	135716434	Titanium
Φ 8×360	135716436	Titanium
Φ 8×375	135716437	Titanium
Φ 9×255	135716525	Titanium
Φ 9×270	135716527	Titanium
Φ 9×285	135716528	Titanium
Φ 9×300	135716530	Titanium
Φ 9×315	135716531	Titanium
Φ 9×330	135716533	Titanium
Φ 9×345	135716534	Titanium
Φ 9×360	135716536	Titanium
Φ 9×375	135716537	Titanium
Φ 10×255	135716625	Titanium
Φ 10×270	135716627	Titanium
Φ 10×285	135716628	Titanium
Φ 10×300	135716630	Titanium
Φ 10×315	135716631	Titanium
Φ 10×330	135716633	Titanium
Φ 10×345	135716634	Titanium
Φ 10×360	135716636	Titanium
Φ 10×375	135716637	Titanium
Φ 11×255	135716725	Titanium
Φ 11×270	135716727	Titanium
Φ 11×285	135716728	Titanium
Φ 11×300	135716730	Titanium
Φ 11×315	135716731	Titanium
Φ 11×330	135716733	Titanium
Φ 11×345	135716734	Titanium
Φ 11×360	135716736	Titanium
Φ 11×375	135716737	Titanium

## TN Tibial Nails

### TibiaNailSystem ETN LockingScrew



Specification	P.N	Material
Φ3.9X26	135700026	Titanium
Φ3.9X28	135700028	Titanium
Φ3.9X30	135700030	Titanium
Φ3.9X32	135700032	Titanium
Φ3.9X34	135700034	Titanium
Φ3.9X36	135700036	Titanium
Φ3.9X38	135700038	Titanium
Φ3.9X40	135700040	Titanium
Φ3.9X42	135700042	Titanium
Φ3.9X44	135700044	Titanium
Φ3.9X46	135700046	Titanium
Φ3.9X48	135700048	Titanium
Φ3.9X50	135700050	Titanium
Φ3.9X52	135700052	Titanium
Φ3.9X54	135700054	Titanium
Φ3.9X56	135700056	Titanium
Φ3.9X58	135700058	Titanium
Φ3.9X60	135700060	Titanium
Φ3.9X64	135700064	Titanium
Φ3.9X68	135700068	Titanium
Φ3.9X72	135700072	Titanium
Φ3.9X76	135700076	Titanium
Φ3.9X80	135700080	Titanium

### Tibia Nail System ETN Locking Screw



Specification	P.N	Material
Φ4.9X20	135400020	Titanium
Φ4.9X24	135400024	Titanium
Φ4.9X28	135400028	Titanium
Φ4.9X30	135400030	Titanium
Φ4.9X32	135400032	Titanium
Φ4.9X34	135400034	Titanium
Φ4.9X36	135400036	Titanium
Φ4.9X38	135400038	Titanium
Φ4.9X40	135400040	Titanium
Φ4.9X42	135400042	Titanium
Φ4.9X44	135400044	Titanium
Φ4.9X46	135400046	Titanium
Φ4.9X48	135400048	Titanium
Φ4.9X50	135400050	Titanium
Φ4.9X52	135400052	Titanium
Φ4.9X56	135400056	Titanium
Φ4.9X60	135400060	Titanium
Φ4.9X64	135400064	Titanium
Φ4.9X68	135400068	Titanium
Φ4.9X70	135400070	Titanium
Φ4.9X72	135400072	Titanium
Φ4.9X76	135400076	Titanium
Φ4.9X80	135400080	Titanium

## TN Tibial Nails

Tibia Nail System ETN  
Locking screw I



Specification	P.N	Material
Φ5×25	135710025	Titanium
Φ5×30	135710030	Titanium
Φ5×35	135710035	Titanium
Φ5×40	135710040	Titanium
Φ5×45	135710045	Titanium
Φ5×50	135710050	Titanium
Φ5×55	135710055	Titanium
Φ5×60	135710060	Titanium
Φ5×65	135710065	Titanium
Φ5×70	135710070	Titanium
Φ5×75	135710075	Titanium
Φ5×80	135710080	Titanium
Φ5×85	135710085	Titanium
Φ5×90	135710090	Titanium

Tibia Nail System ETN  
End cap(long)



Specification	P.N	Material
5	135711105	Titanium

Tibia Nail System ETN  
End cap



Specification	P.N	Material
5	135711005	Titanium
10	135711010	Titanium
15	135711015	Titanium
20	135711020	Titanium



**BONE**  
TRAUMA & SPINE SOLUTIONS









BONE - Ti es una marca Tocamedic Colombia

Carrera 16 No. 13C - 78  
Valledupar - Cesar - Colombia  
Tel: (57)(5) 589 85 22  
Cel: (57) 310 459 1567  
[info@bone-ti.com](mailto:info@bone-ti.com)  
[ventas@tocamedic.com](mailto:ventas@tocamedic.com)

  [@bone.tioficial](https://www.instagram.com/bone.tioficial)

[www.bone-ti.com](http://www.bone-ti.com)

 ISO 9001:2008  
ISO 13485:2003 